



PRODUCT & ENGINEERING MANUAL

TABLE OF CONTENTS

PANEL PROFILE AND FASTENER REQUIREMENTS	2
CR0010PE – Panel Profile.....	2
CR0020PE – Building Elevation	3
DA0001 – Standard Structural Fastener Spacing.....	4
DA0002 – Standard Sidelap Fastener Spacing	5
LOW EAVE DETAILS.....	6
DD0010 – Low Eave (Gutter) @ Standard Wall Panel – Eave Strut	6
DD0030 – Low Eave (Gutter) @ Masonry Wall – Eave Strut	7
DD0300 – Low Eave (Horizontal Gutter) @ Standard Wall Panel	8
DD0400 – Low Eave (Horizontal Gutter) @ Masonry Wall	9
DC0010 – Sculptured Eave @ Standard Wall Panel – Eave Strut.....	10
DC0030 – Sculptured Eave @ Masonry Wall – Eave Strut	11
HIGH EAVE DETAILS	12
DH0006 – High Eave Sculptured Trim @ Standard Wall Panel	12
DH0020 – High Eave Sculptured Trim @ Masonry Wall	13
DH0106 – High Eave Simple Trim @ Standard Wall Panel	14
DH0120 – High Eave Simple Trim @ Masonry Wall	15
DI0010 – High Eave Parapet Transition @ Standard Wall Panel.....	16
DI0090 – High Eave Parapet Transition @ Masonry Wall.....	17
RAKE DETAILS.....	18
DE0010 – Sculptured Rake Trim @ Standard Wall Panel.....	18
DE0020 – Sculptured Rake Trim @ Masonry Wall.....	19
DE0110 – Simple Rake Trim @ Standard Wall	20
DE0120 – Simple Rake Trim @ Masonry Wall.....	21
DF0010 – Rake Parapet Transition @ Standard Wall Panel	22
DF0020 – Rake Parapet Transition @ Masonry Wall	23
RIDGE DETAILS	24
DG0011 – Ridge Condition With Die Formed Ridge Cap	24
DG0031 – Ridge Condition With Press-Broke Ridge Cap	25
PANEL LAP DETAILS	26
DA0071 – Panel Lap Installation.....	26
HIP AND VALLEY DETAILS	27
DN0010 – Hip Condition Detail	27
DD0100 – Gutter Corner Detail at Hip	28
DN0020 – Valley Condition Detail.....	29
DD0200 – Gutter Corner Detail at Valley.....	30



PRODUCT & ENGINEERING MANUAL

PANEL PROFILE AND FASTENER REQUIREMENTS

CR0010PE – PANEL PROFILE

Standard Classic Roof Panels Are:

- 26 Gauge
- Galvalume finish, with a purlin bearing leg.
- Other colors are available, with a purlin bearing leg.

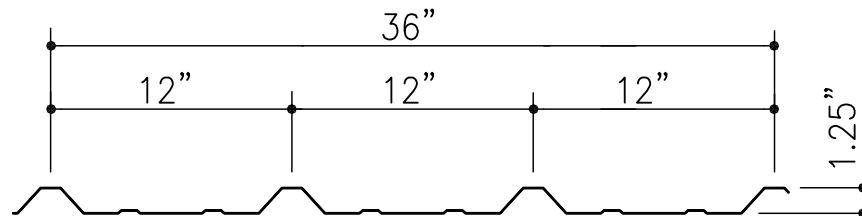

CLASSIC ROOF PANEL

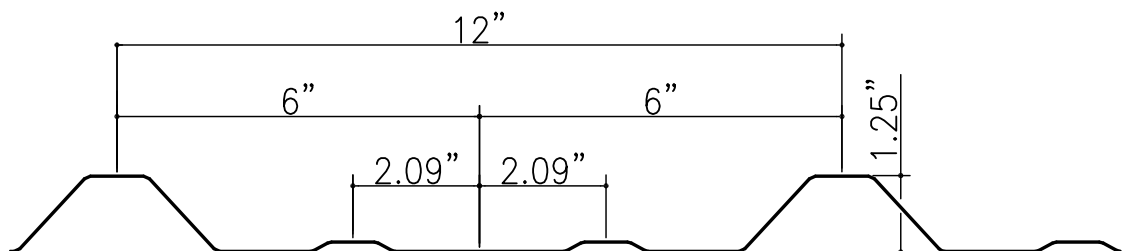

ENLARGED SECTION

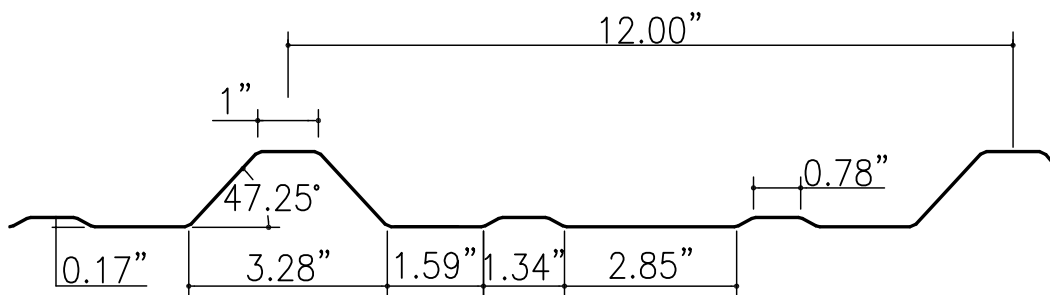

ENLARGED SECTION



PRODUCT & ENGINEERING MANUAL

CR0020PE – BUILDING ELEVATION

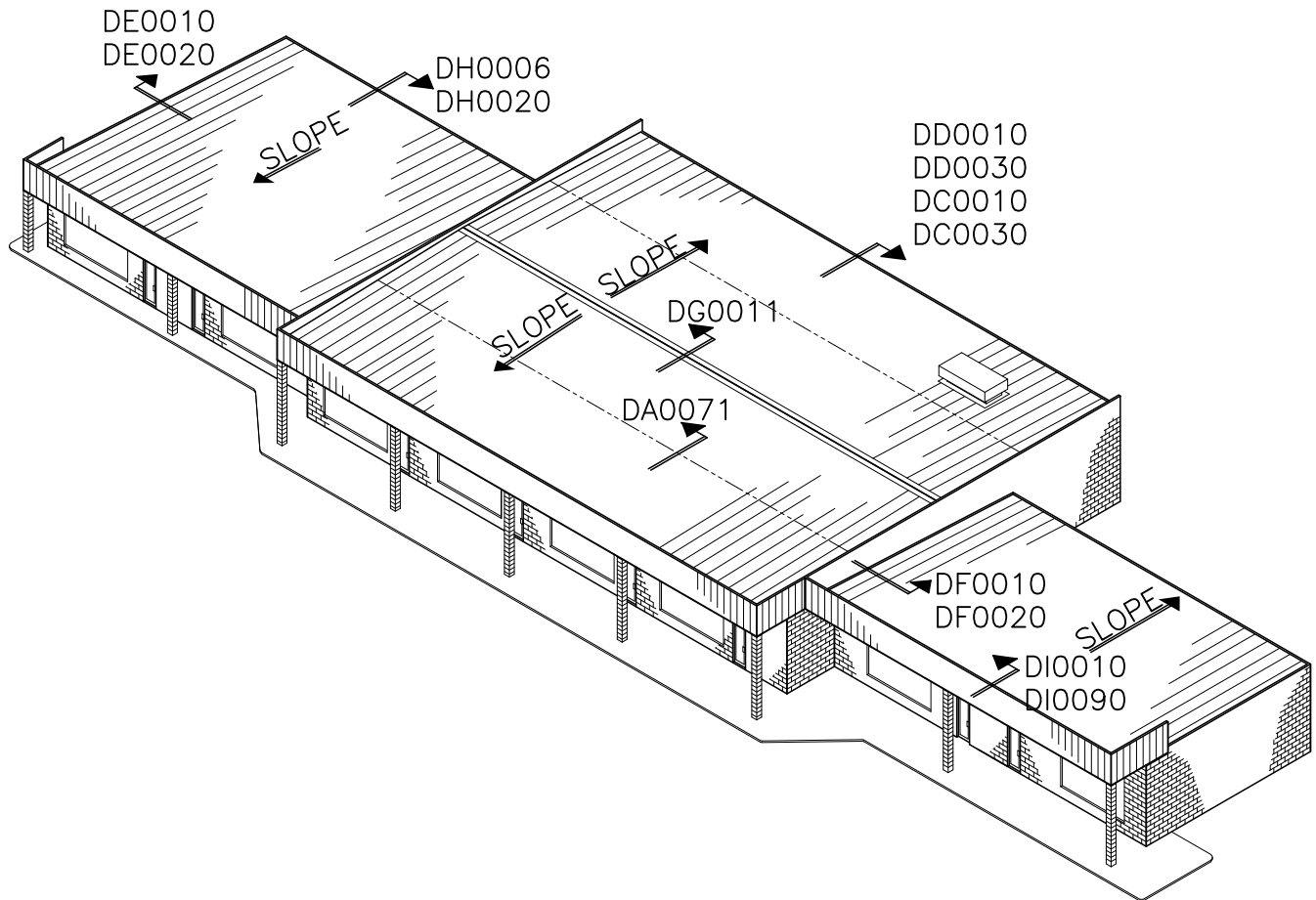

LAST REVISION
DATE: 02/16/15
BY: AK CHK: EGB

DETAIL NAME IF APPLICABLE
CR0020PE.DWG

11.4.3



PRODUCT & ENGINEERING MANUAL

DA0002 – STANDARD SIDELAP FASTENER SPACING

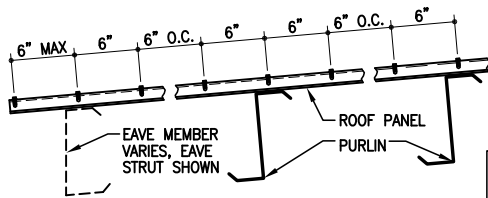

FIRST TWO LOW EAVE SPANS
(EACH SUPPORT AND 6" ON CENTER BETWEEN SUPPORTS)

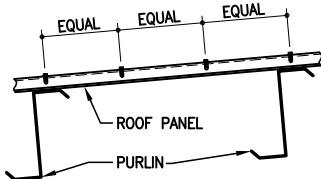

SPANS > OR = TO 5'-0"
(EACH SUPPORT AND 1/3 POINTS BETWEEN SUPPORTS)

SEE THE CLASSIC ROOF STRUCTURAL FASTENER SPACING DETAIL FOR STRUCTURAL FASTENER SPACING

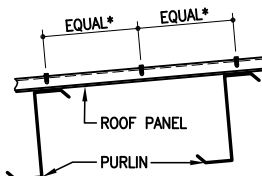

SPANS LESS THAN 5'-0"

NON-UL 90	EACH SUPPORT AND MIDPOINT BETWEEN SUPPORTS.
UL 90	EACH SUPPORT AND SPACED EQUALLY BETWEEN SUPPORTS. NOT TO EXCEED 20" (1'-8").

SEE DETAILS BELOW LEFT FOR SIDE LAP FASTENER SPACING AT THE REMAINDER OF THE PANEL RUN

SIDE LAP FASTENERS (MK. H1050) AT EACH SUPPORT AND 6" ON CENTER BETWEEN SUPPORTS AT THE FIRST TWO LOW EAVE PURLIN SPANS

TYPICAL SIDE LAP

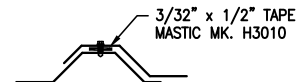
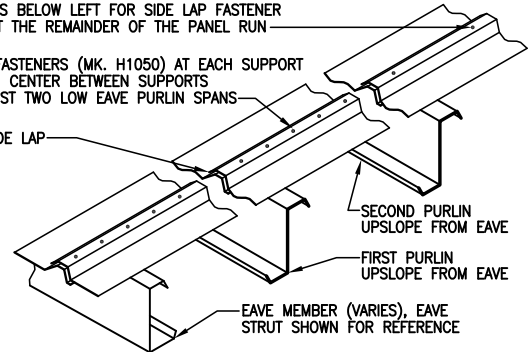

SIDE LAP MASTIC DETAIL
(AT FULL LENGTH OF ALL SIDE LAPS)

CLASSIC ROOF SIDE LAP FASTENER SPACING (STANDARD)



PRODUCT & ENGINEERING MANUAL

LOW EAVE DETAILS

DD0010 – LOW EAVE (GUTTER) @ STANDARD WALL PANEL – EAVE STRUT

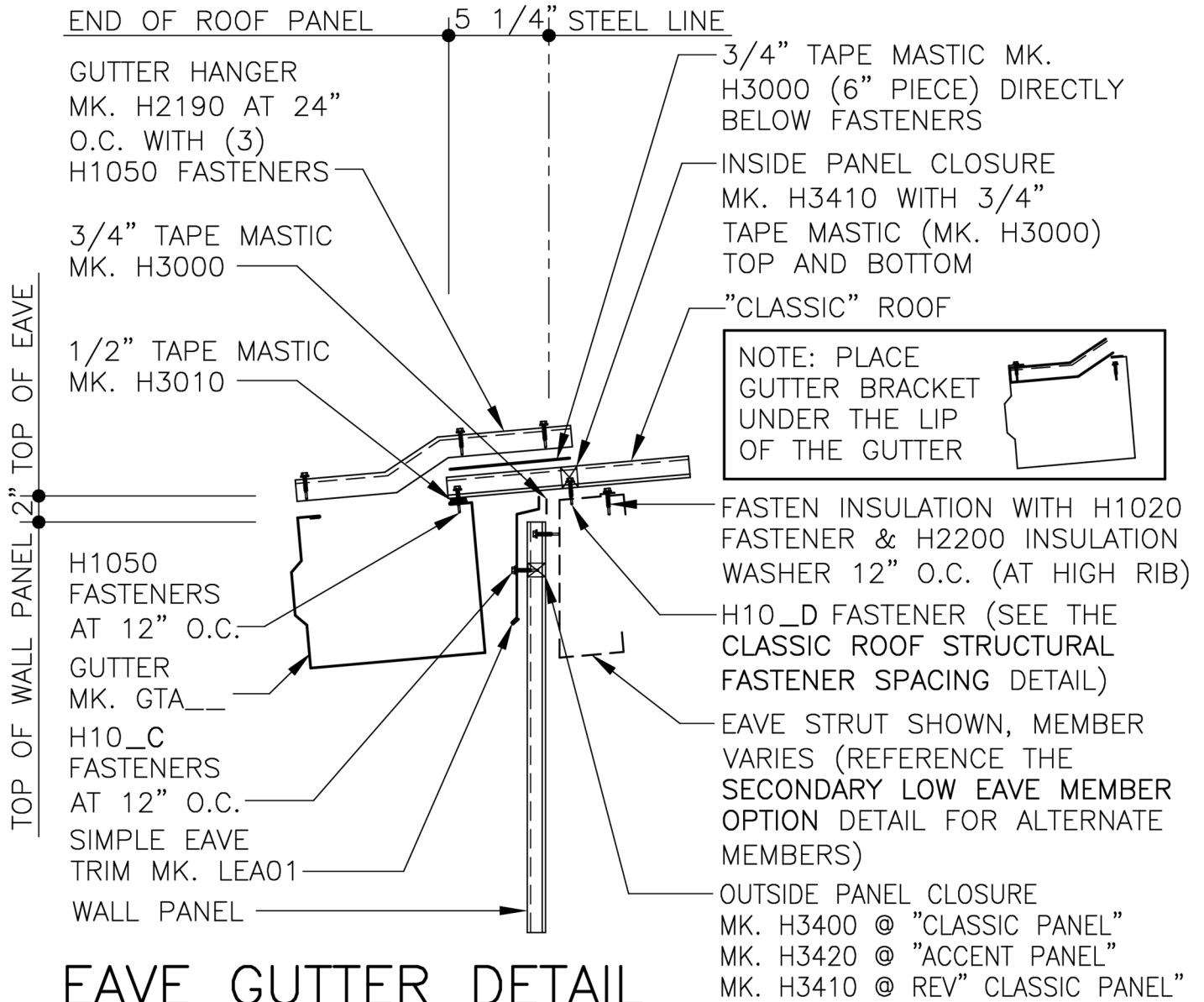

EAVE GUTTER DETAIL

"CLASSIC ROOF"

SEE WALL SHEETING ERECTION NOTES FOR
WALL PANEL FASTENER LOCATIONS

DD0010

WALL PANEL CLOSURES SHOWN HERE ARE OPTIONAL

LAST REVISION
DATE: 03/8/17
BY: EGB CHK: KMC

DETAIL NAME IF APPLICABLE
DD0010.DWG

11.4.6



PRODUCT & ENGINEERING MANUAL

DD0030 – LOW EAVE (GUTTER) @ MASONRY WALL – EAVE STRUT

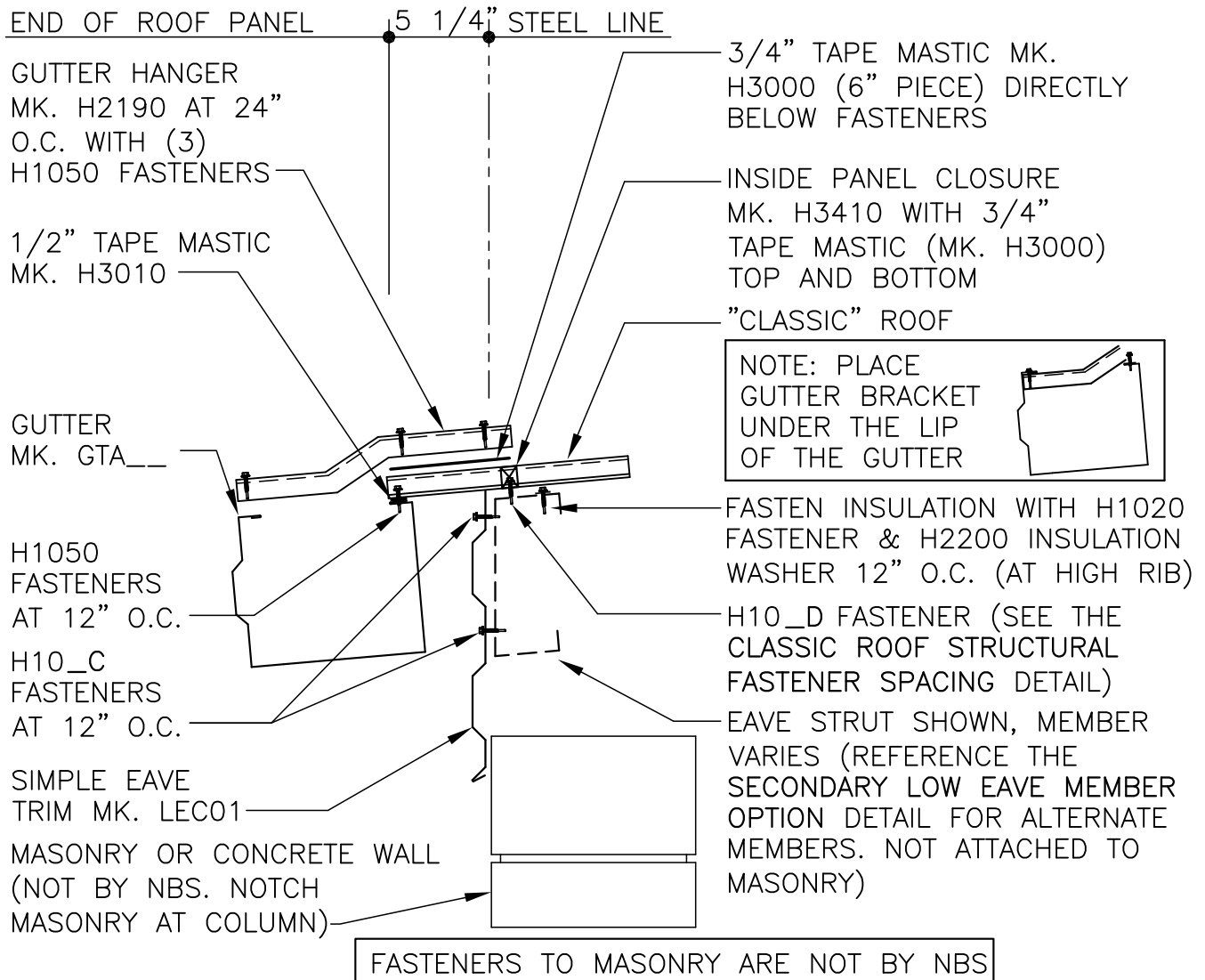

EAVE GUTTER DETAIL

"CLASSIC" ROOF AT MASONRY WALL

DD0030

LAST REVISION
DATE: 02/16/15
BY: AK CHK: EGB

DETAIL NAME IF APPLICABLE
DD0030.DWG

11.4.7



PRODUCT & ENGINEERING MANUAL

DD0300 – LOW EAVE (HORIZONTAL GUTTER) @ STANDARD WALL PANEL

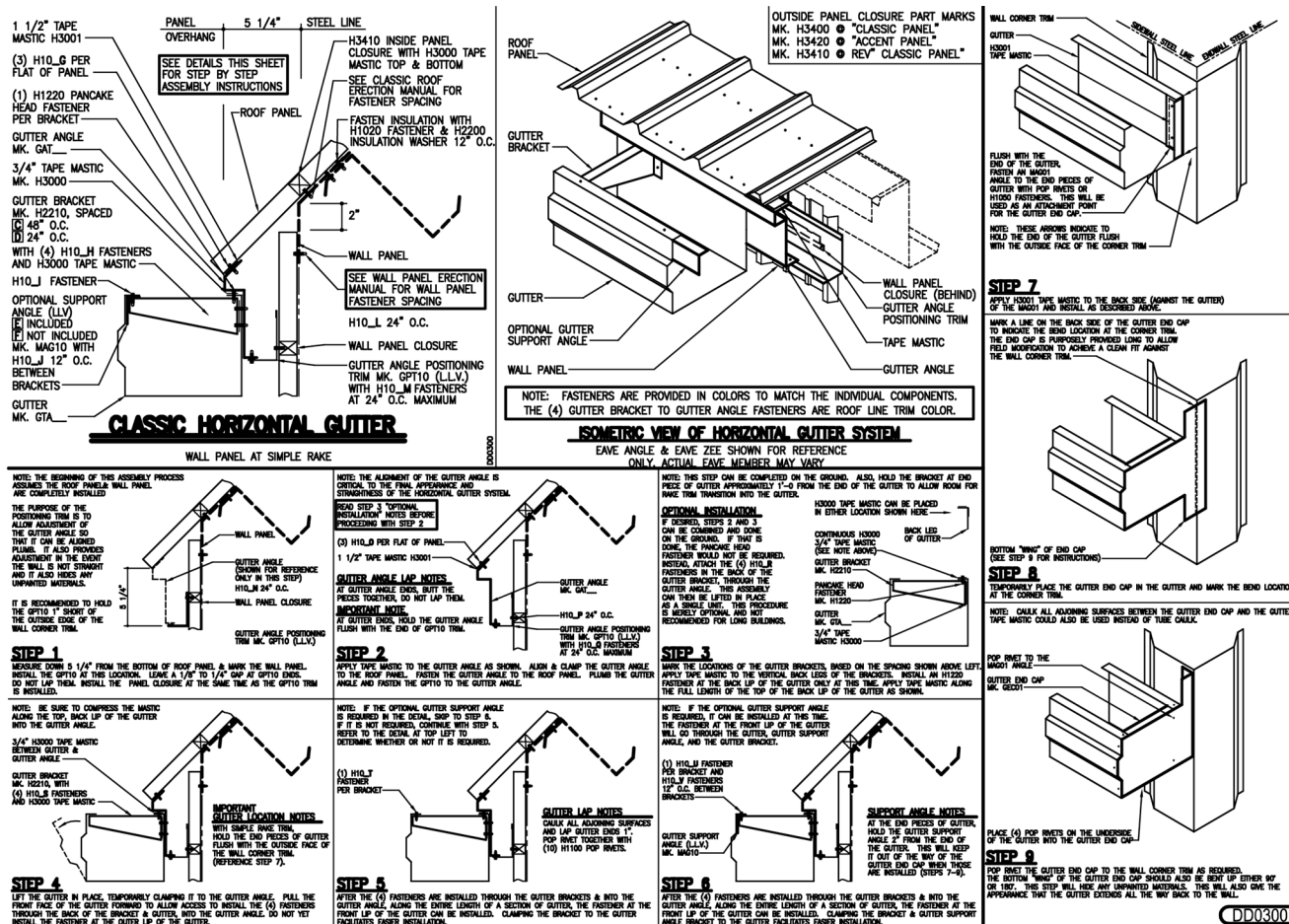

WALL PANEL CLOSURES SHOWN HERE ARE OPTIONAL

LAST REVISION
 DATE: 03/8/17
 BY: EGB CHK: K

DETAIL NAME IF APPLICABLE
 DD0300.DWG

11.4.8



PRODUCT & ENGINEERING MANUAL

DD0400 – LOW EAVE (HORIZONTAL GUTTER) @ MASONRY WALL

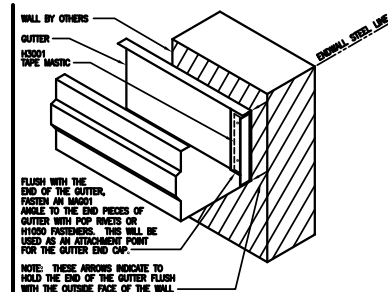
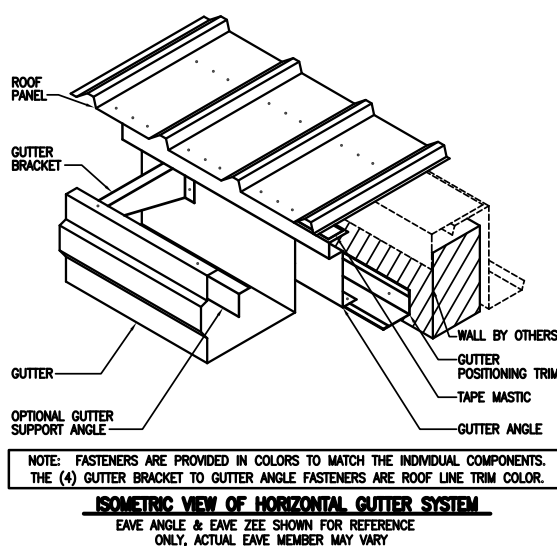
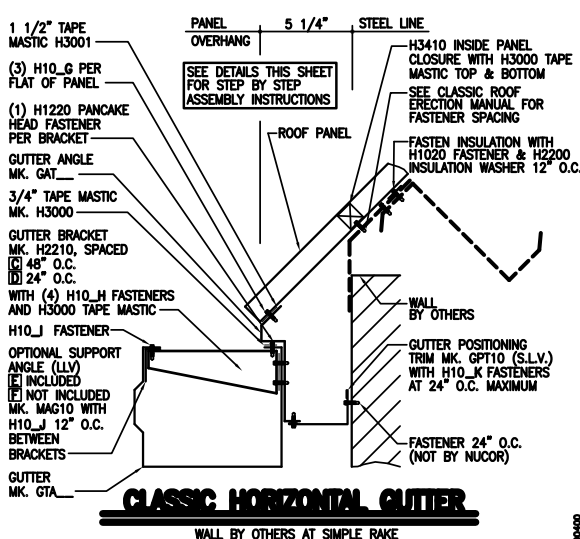

STEP 7

APPLY H3001 TAPE MASTIC TO THE BACK SIDE (AGAINST THE GUTTER) OF THE MASONRY AND INSTALL AS DESCRIBED ABOVE.

MARK A LINE ON THE BACK SIDE OF THE GUTTER END CAP TO INDICATE THE BEND LOCATION AT THE WALL. THE END CAP IS PURPOSELY PROVIDED LONG TO ALLOW FIELD MODIFICATION TO ACHIEVE A CLEAN FIT AGAINST THE WALL.

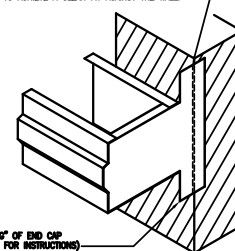

STEP 8

TEMPORARILY PLACE THE GUTTER END CAP IN THE GUTTER AND MARK THE BEND LOCATION AT THE WALL CORNER.

NOTE: CHALK ALL ADJOINING SURFACES BETWEEN THE GUTTER END CAP AND THE GUTTER. TAPE MASTIC COULD ALSO BE USED INSTEAD OF TUBE CHALK.

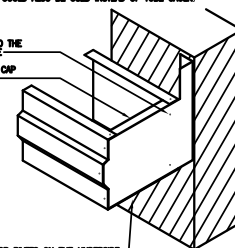

STEP 9

FASTEN THE GUTTER END CAP TO THE WALL AS REQUIRED. THE BOTTOM "WING" OF THE GUTTER END CAP SHOULD ALSO BE BENT UP EITHER 90° OR 180°. THIS STEP WILL HIDE ANY UNPAINTED MATERIALS. THIS WILL ALSO GIVE THE APPEARANCE THAT THE GUTTER EXTENDS ALL THE WAY BACK TO THE WALL.

DD0400

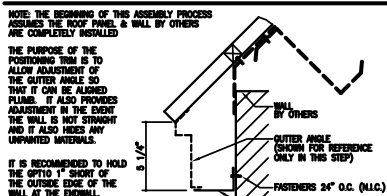

STEP 1

MEASURE DOWN 5 1/4" FROM THE BOTTOM OF ROOF PANEL & MARK THE WALL. INSTALL THE OPT10 AT THIS LOCATION. LEAVE A 1/8" TO 1/4" GAP AT OPT10 ENDS. DO NOT LAP THEM.

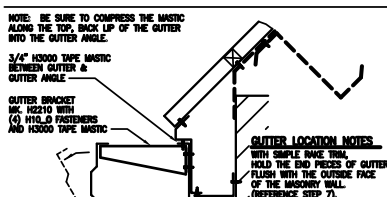

STEP 4

LIFT THE GUTTER IN PLACE, TEMPORARILY CLAMPING IT TO THE GUTTER ANGLE. PULL THE FRONT FACE OF THE GUTTER FORWARD TO ALLOW ACCESS TO INSTALL THE (4) FASTENERS THROUGH THE BACK OF THE BRACKET & GUTTER, INTO THE GUTTER ANGLE. DO NOT YET INSTALL THE FASTENER AT THE GUTTER LIP OF THE GUTTER.

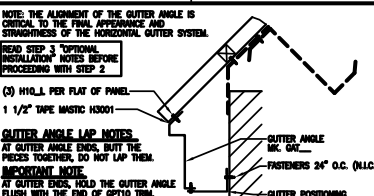

STEP 2

APPLY TAPE MASTIC TO THE GUTTER ANGLE AS SHOWN. ALIGN & CLAMP THE GUTTER ANGLE TO THE ROOF PANEL. FASTEN THE GUTTER ANGLE TO THE ROOF PANEL. FLUSH THE GUTTER ANGLE AND FASTEN THE OPT10 TO THE GUTTER ANGLE.

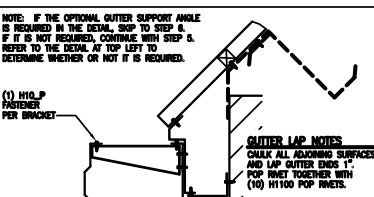

STEP 5

AFTER THE (4) FASTENERS ARE INSTALLED THROUGH THE GUTTER BRACKETS & INTO THE GUTTER ANGLE, ALONG THE ENTIRE LENGTH OF A SECTION OF GUTTER, THE FASTENER AT THE FRONT LIP OF THE GUTTER CAN BE INSTALLED. CLAMPING THE BRACKET TO THE GUTTER FACILITATES EASIER INSTALLATION.

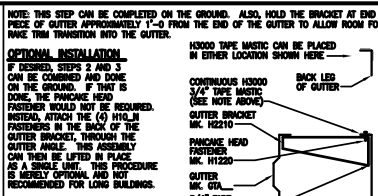

STEP 3

MARK THE LOCATIONS OF THE GUTTER BRACKETS, BASED ON THE SPACING SHOWN ABOVE LEFT. APPLY TAPE MASTIC TO THE VERTICAL, BACK LEGS OF THE BRACKETS. INSTALL AN H1220 FASTENER AT THE BACK LIP OF THE GUTTER ONLY AT THIS TIME. APPLY TAPE MASTIC ALONG THE FULL LENGTH OF THE TOP OF THE BACK LIP OF THE GUTTER AS SHOWN.

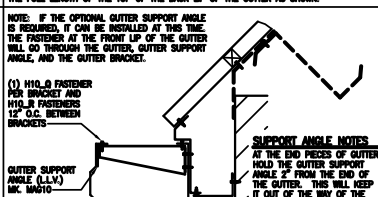

STEP 6

AFTER THE (4) FASTENERS ARE INSTALLED THROUGH THE GUTTER BRACKETS & INTO THE GUTTER ANGLE, ALONG THE ENTIRE LENGTH OF A SECTION OF GUTTER, THE FASTENER AT THE FRONT LIP OF THE GUTTER CAN BE INSTALLED. CLAMPING THE BRACKET & GUTTER SUPPORT ANGLE BRACKET TO THE GUTTER FACILITATES EASIER INSTALLATION.



PRODUCT & ENGINEERING MANUAL

DC0010 – SCULPTURED EAVE @ STANDARD WALL PANEL – EAVE STRUT

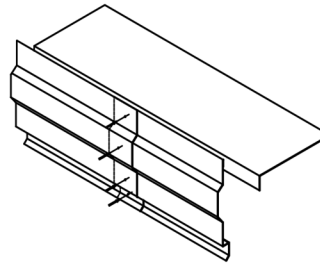
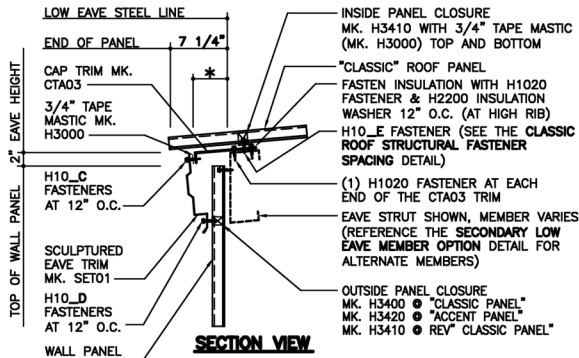

FOLLOW THE **CLASSIC ROOF ERECTION MANUAL** WITH THE FOLLOWING EXCEPTIONS AT SCULPTURED EAVE TRIM APPLICATIONS:

- 1) THE CTA03 CAP TRIM ON THE EAVE STRUT MUST BE ERECTED PRIOR TO INSTALLING THE ROOF PANEL AND THE SCULPTURED EAVE TRIM. (SEE THE CLASSIC ROOF ERECTION MANUAL).
- 2) INSULATION MUST BE INSTALLED PRIOR TO INSTALLING THE ROOF PANELS. INSULATION IS NOT SHOWN IN THIS DETAIL FOR CLARITY. (SEE THE CLASSIC ROOF ERECTION MANUAL FOR PROPER INSTALLATION OF THE INSULATION)
- 3) INSTALL 3/4" TAPE MASTIC (MK. H3000) TO THE SHORT VERTICAL LEG OF THE CTA03 CAP TRIM. EXTEND THE SCULPTURED EAVE TRIM SET01, 2 1/4" PAST THE ENDWALL STEEL LINE (1" PAST THE EDGE OF THE WALL CORNER TRIM). COPE THE BOTTOM VERTICAL LEG FLUSH WITH THE EDGE OF THE CORNER TRIM. INSTALL OUTSIDE CLOSURE AS SHOWN (IF REQUIRED) THEN FASTEN THE TRIM TO THE WALL PANEL AND CAP TRIM WITH H10_F FASTENERS AT 12" O.C.
- 4) APPLY A CONTINUOUS BEAD OF TUBE CAULK (MK. H3152) AROUND THE PERIMETER OF THE RAKE CORNER CAP, CLOSE TO THE INSIDE EDGE OF THE CAP.
- 5) INSERT THE CORNER CAP INTO THE SCULPTURED RAKE TRIM, LEAVING 1/2" EXPOSURE ALL AROUND. FASTEN WITH (3) H1100 COLORED POP RIVETS AT FRONT ONLY.
- 6) INSTALL THE RAKE CAP AT THE RAKE EDGE OF THE SCULPTURED EAVE TRIM & 1/2" FROM THE FIRST VERTICAL FACE OF THE SCULPTURED EAVE (AS SHOWN AT LEFT). UTILIZE TUBE CAULK (MK. H3152) AROUND THE PERIMETER OF EDGE OF THE RAKE CAP.
- 7) APPLY A BEAD OF TUBE CAULK (MK. H3152) 1 1/2" FROM THE FACE OF THE EAVE TRIM ALONG THE RAKE SIDE OF THE CORNER CAP. THIS BEAD SHOULD INCLUDE BOTH THE TOP & BOTTOM EDGES OF THE CORNER CAP.
- 8) INSTALL THE RAKE TRIM RTA PER THE CLASSIC ROOF ERECTION MANUAL, 1/2" FROM THE FACE OF THE SCULPTURED EAVE TRIM.
- 9) FASTEN THE CORNER CAP AND THE RAKE CAP, AS SHOWN AT LEFT, WITH (15) COLORED POP RIVETS (MK. H1100).

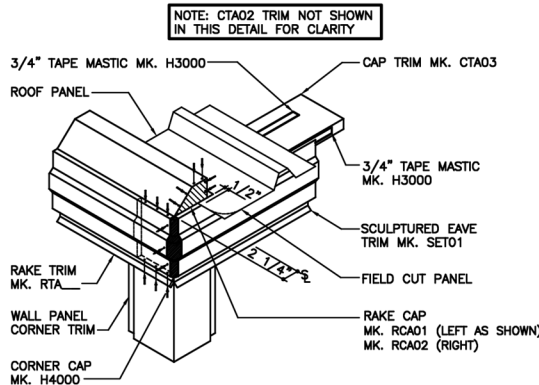
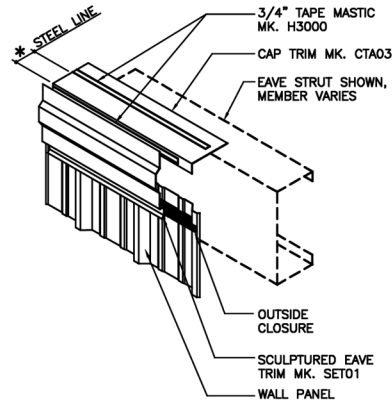

SCULPTURED EAVE TRIM DETAIL

SEE WALL SHEETING ERECTION NOTES FOR WALL PANEL FASTENER LOCATIONS

DC0010

WALL PANEL CLOSURES SHOWN HERE ARE OPTIONAL

LAST REVISION
DATE: 03/8/17
BY: EGB CHK: KMC

DETAIL NAME IF APPLICABLE
DC0010.DWG

11.4.10



PRODUCT & ENGINEERING MANUAL

DC0030 – SCULPTURED EAVE @ MASONRY WALL – EAVE STRUT

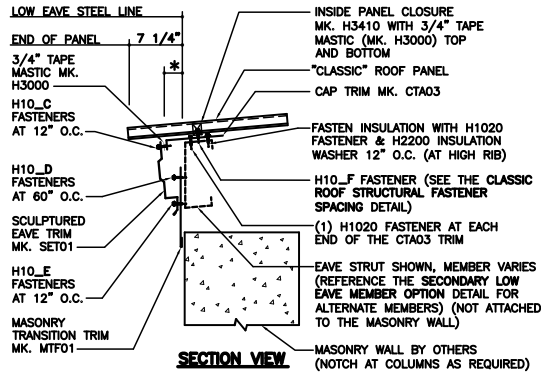

1	3/4"	AT 1/2:12 ROOF SLOPE
2	1/4"	AT 1:12 ROOF SLOPE
2	7/8"	AT 2:12 ROOF SLOPE
3	5/16"	AT 3:12 ROOF SLOPE
3	13/16"	AT 4:12 ROOF SLOPE

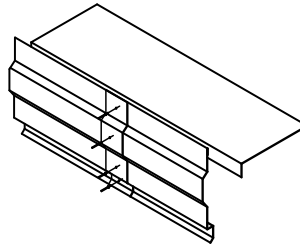

SCULPTURED EAVE TRIM SPLICE

APPLY A CONTINUOUS BEAD OF TUBE CAULK (MK. H3152) TO THE END OF THE ADJOINING TRIM PIECE AND LAP 1". FASTEN WITH (4) COLORED POP RIVETS (MK. H1100) AS SHOWN.

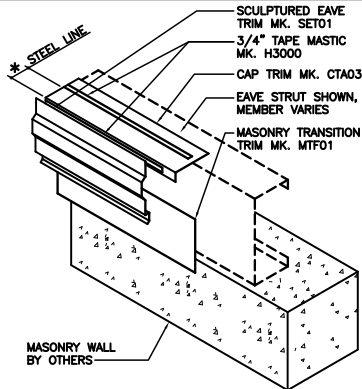

ISOMETRIC VIEW AT LOW EAVE

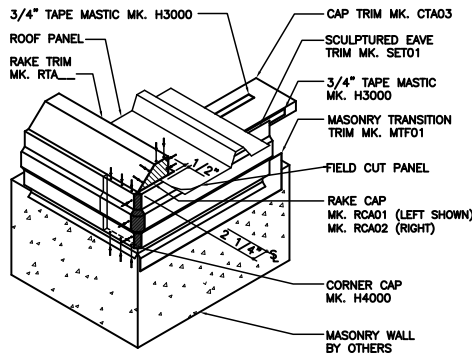

ISOMETRIC VIEW AT CORNER

POP RIVET

FOLLOW THE **CLASSIC ROOF ERECTION MANUAL** WITH THE FOLLOWING EXCEPTIONS AT SCULPTURED EAVE TRIM APPLICATIONS:

- 1) THE CTA03 CAP TRIM ON THE EAVE STRUT MUST BE ERECTED PRIOR TO INSTALLING THE ROOF PANEL AND THE SCULPTURED EAVE TRIM. (SEE THE CLASSIC ROOF ERECTION MANUAL).
- 2) INSULATION MUST BE INSTALLED PRIOR TO INSTALLING THE ROOF PANELS. INSULATION IS NOT SHOWN IN THIS DETAIL FOR CLARITY. (SEE THE CLASSIC ROOF ERECTION MANUAL FOR PROPER INSTALLATION OF THE INSULATION)
- 3) THE MASONRY TRANSITION TRIM MUST BE INSTALLED PRIOR TO INSTALLING THE SCULPTURED EAVE TRIM.
- 4) INSTALL 3/4" TAPE MASTIC (MK. H3000) TO THE SHORT VERTICAL LEG OF THE CTA03 CAP TRIM. EXTEND THE SCULPTURED EAVE TRIM 2 1/4" PAST THE ENDWALL STEEL LINE. COPE THE BOTTOM VERTICAL OF THE CORNER TRIM 1". FASTEN THE TRIM TO THE EAVE STRUT AND CAP TRIM WITH H10_G FASTENERS AT 12" O.C.
- 5) APPLY A CONTINUOUS BEAD OF TUBE CAULK (MK. H3152) AROUND THE PERIMETER OF THE RCA CORNER CAP, CLOSE TO THE INSIDE EDGE OF THE CAP.
- 6) INSERT THE CORNER CAP INTO THE SCULPTURED RAKE TRIM, LEAVING 1/2" EXPOSURE ALL AROUND. FASTEN WITH (3) H1100 COLORED POP RIVETS AT FRONT ONLY.
- 7) INSTALL THE RAKE CAP AT THE RAKE EDGE OF THE SCULPTURED EAVE TRIM & 1/2" FROM THE FIRST VERTICAL FACE OF THE SCULPTURED EAVE (AS SHOWN AT LEFT). UTILIZE TUBE CAULK (MK. H3152) AROUND THE PERIMETER OF EDGE OF THE RAKE CAP.
- 8) APPLY A BEAD OF TUBE CAULK (MK. H3152) 1 1/2" FROM THE FACE OF THE EAVE TRIM ALONG THE RAKE SIDE OF THE CORNER CAP. THIS BEAD SHOULD INCLUDE BOTH THE TOP & BOTTOM EDGES OF THE CORNER CAP.
- 9) INSTALL THE RAKE TRIM RTA PER THE CLASSIC ROOF ERECTION MANUAL, 1/2" FROM THE FACE OF THE SCULPTURED EAVE TRIM.
- 10) FASTEN THE CORNER CAP AND THE RAKE CAP, AS SHOWN AT LEFT, WITH (15) COLORED POP RIVETS (MK. H1100).

SCULPTURED EAVE TRIM DETAIL

DETAIL AT MASONRY WALL

DC0030

LAST REVISION
DATE: 02/16/15
BY: AK CHK: EGB

DETAIL NAME IF APPLICABLE
DC0030.DWG

11.4.11



PRODUCT & ENGINEERING MANUAL

HIGH EAVE DETAILS

DH0006 – HIGH EAVE SCULPTURED TRIM @ STANDARD WALL PANEL

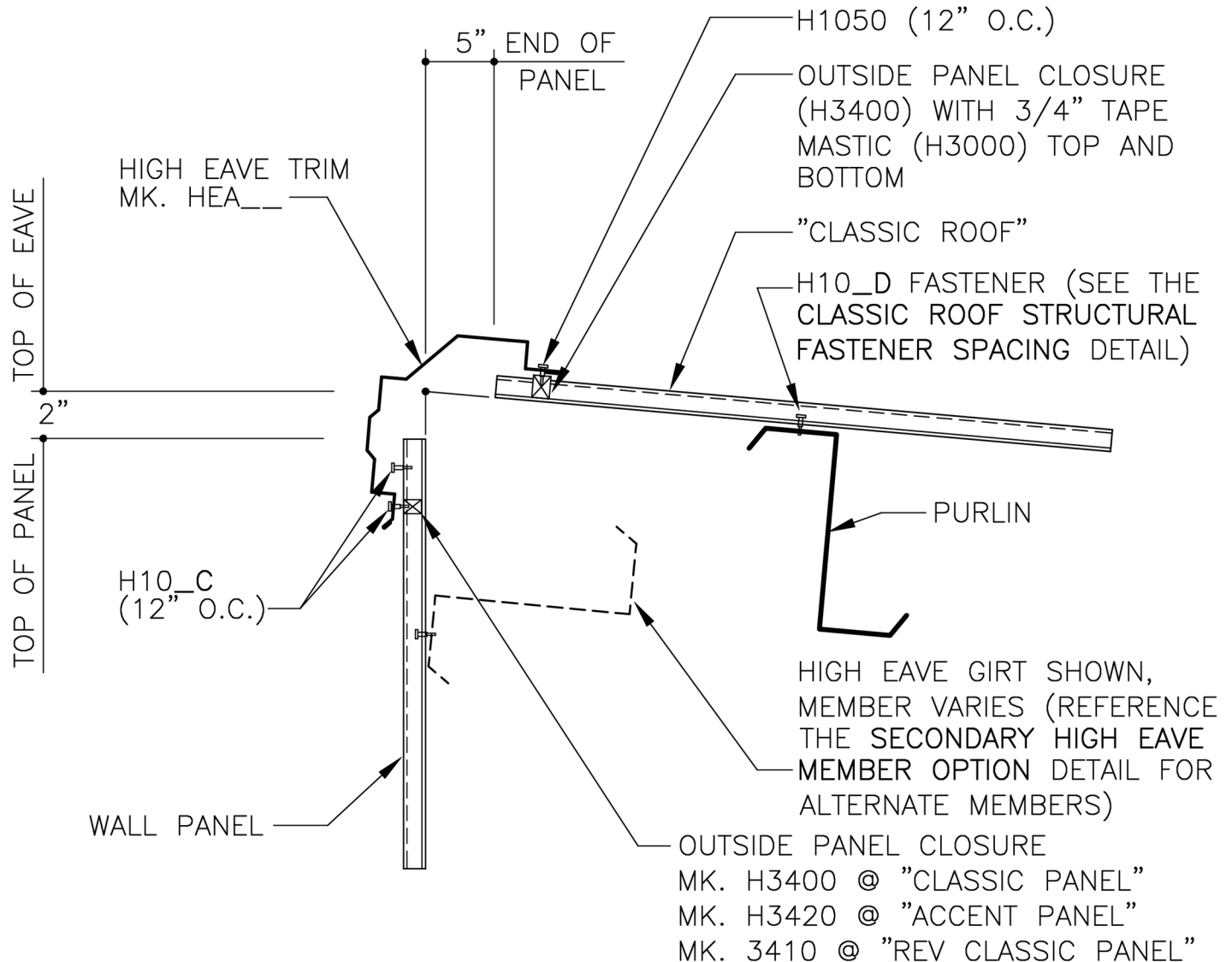

SCULPTURED EAVE DETAIL

"CLASSIC ROOF" AT STANDARD WALL PANEL
SEE WALL SHEETING ERECTION NOTES FOR WALL
PANEL FASTENER LOCATIONS

DH0006

WALL PANEL CLOSURES SHOWN HERE ARE OPTIONAL

LAST REVISION
DATE: 03/08/17
BY: EGB CHK: KMC

DETAIL NAME IF APPLICABLE
DH0006.DWG

11.4.12



PRODUCT & ENGINEERING MANUAL

DH0020 – HIGH EAVE SCULPTURED TRIM @ MASONRY WALL

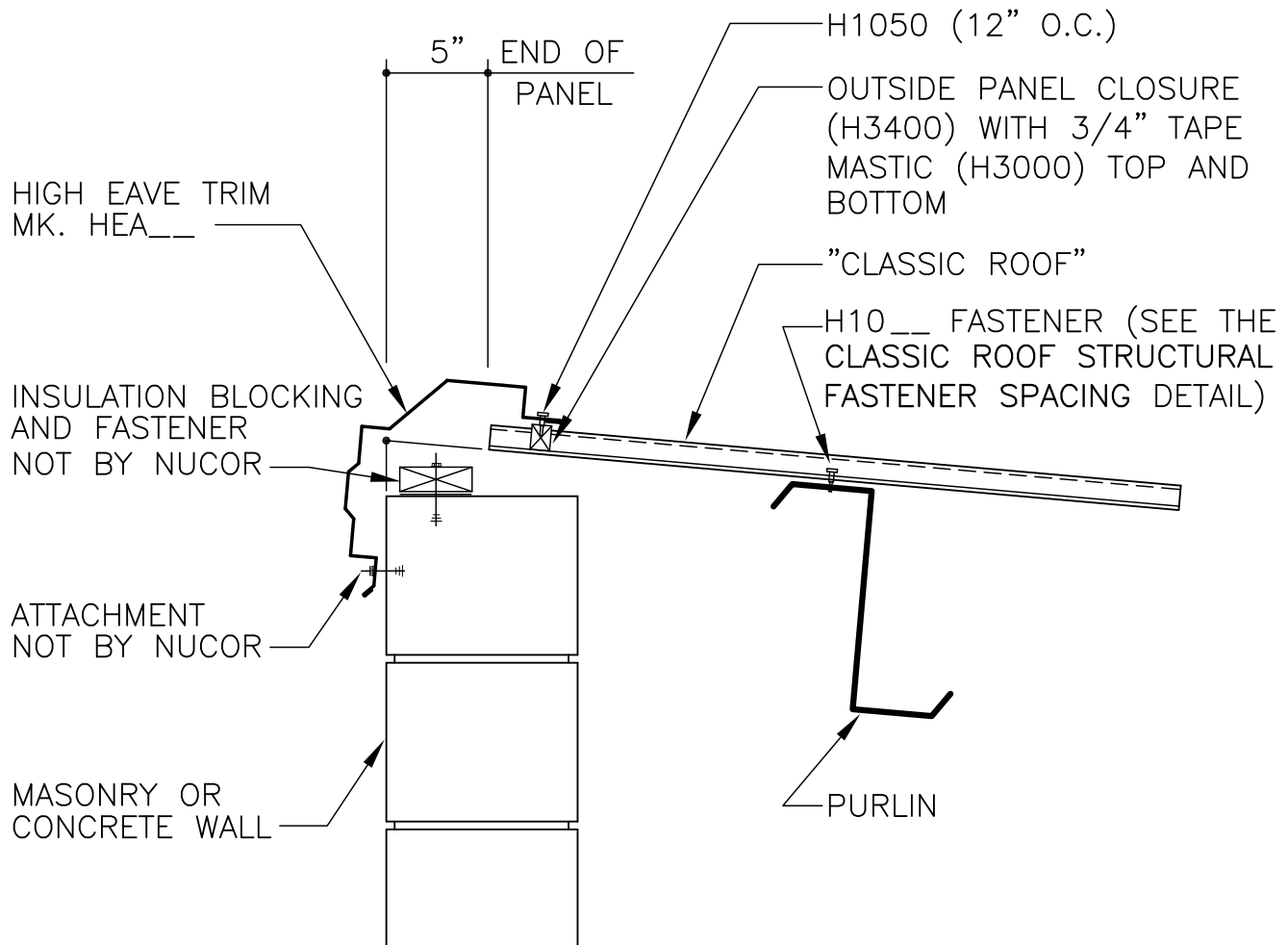

SCULPTURED EAVE DETAIL

"CLASSIC ROOF" AT MASONRY WALL

DH0020

LAST REVISION
DATE: 02/16/15
BY: AK CHK: EGB

DETAIL NAME IF APPLICABLE
DH0020.DWG

11.4.13



PRODUCT & ENGINEERING MANUAL

DH0106 – HIGH EAVE SIMPLE TRIM @ STANDARD WALL PANEL

TRIM LAP NOTE:
CAULK ADJOINING SURFACES
(H3152), LAP 1" AND FASTEN
WITH (5) POP RIVETS (H1100)

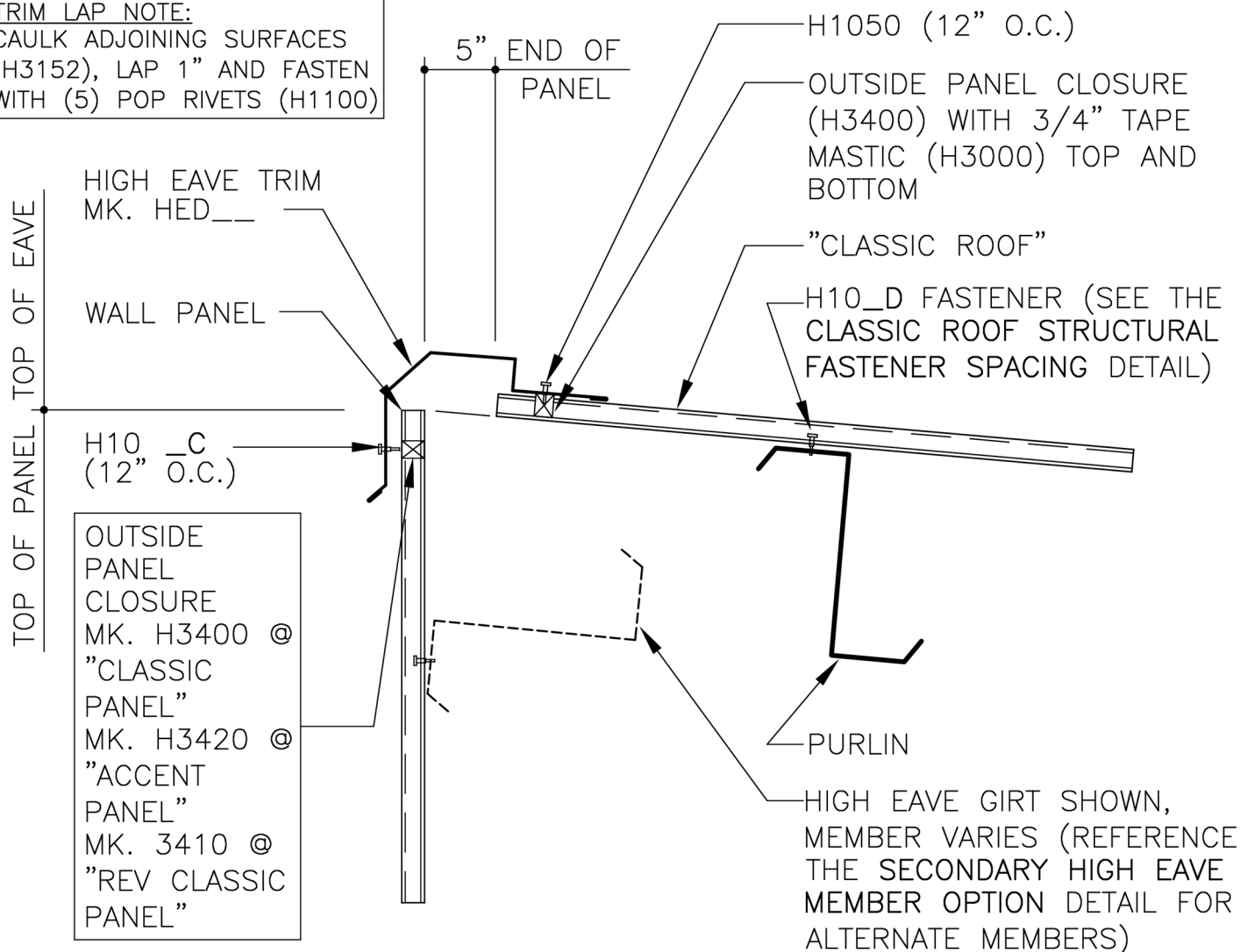

SIMPLE HIGH EAVE DETAIL

"CLASSIC ROOF" AT STANDARD WALL PANEL
SEE WALL SHEETING ERECTION NOTES FOR WALL
PANEL FASTENER LOCATIONS

DH0106

WALL PANEL CLOSURES SHOWN HERE ARE OPTIONAL

LAST REVISION
DATE: 03/08/17
BY: EGB CHK: KMC

DETAIL NAME IF APPLICABLE
DH0106.DWG

11.4.14



PRODUCT & ENGINEERING MANUAL

DI0010 – HIGH EAVE PARAPET TRANSITION @ STANDARD WALL PANEL

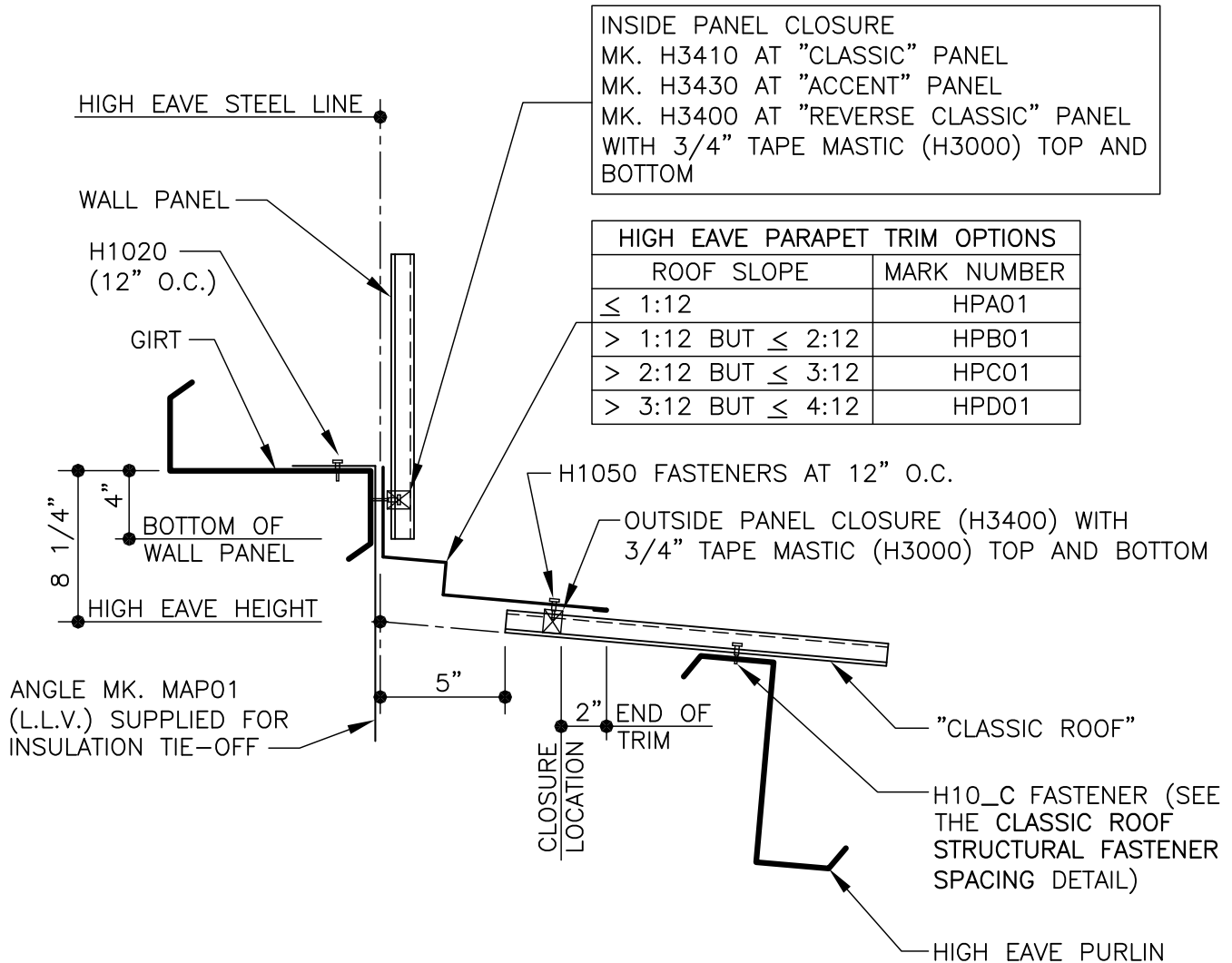

HIGH EAVE PARAPET DETAIL

"CLASSIC ROOF"

SEE WALL SHEETING ERECTION NOTES FOR WALL PANEL FASTENER LOCATIONS

DI0010



PRODUCT & ENGINEERING MANUAL

DI0090 – HIGH EAVE PARAPET TRANSITION @ MASONRY WALL

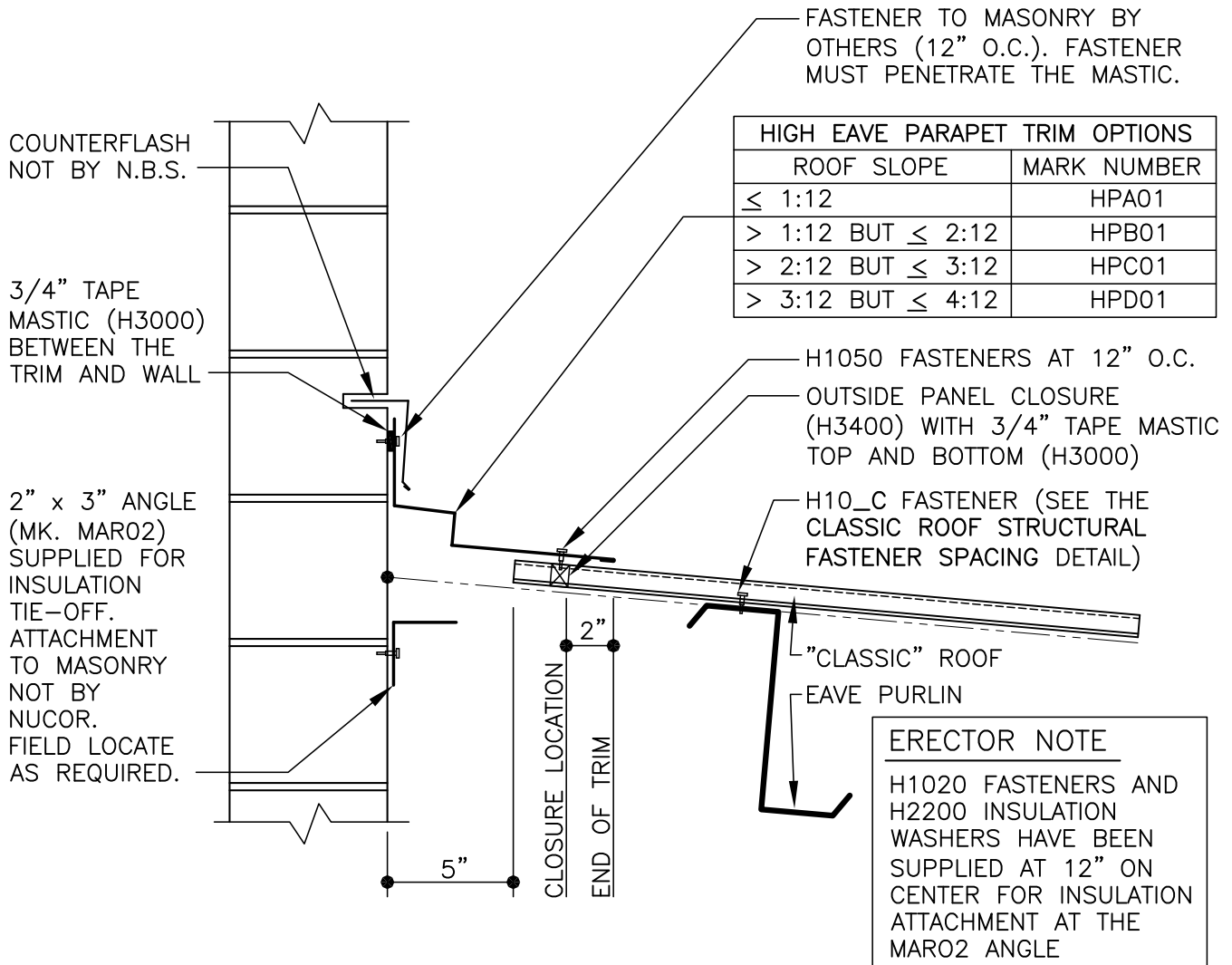

HIGH EAVE PARAPET DETAIL

"CLASSIC ROOF" AT MASONRY WALL

DI0090

LAST REVISION
DATE: 02/16/15
BY: AK CHK: EGB

DETAIL NAME IF APPLICABLE
DI0090.DWG

11.4.17



PRODUCT & ENGINEERING MANUAL

RAKE DETAILS

DE0010 – SCULPTURED RAKE TRIM @ STANDARD WALL PANEL

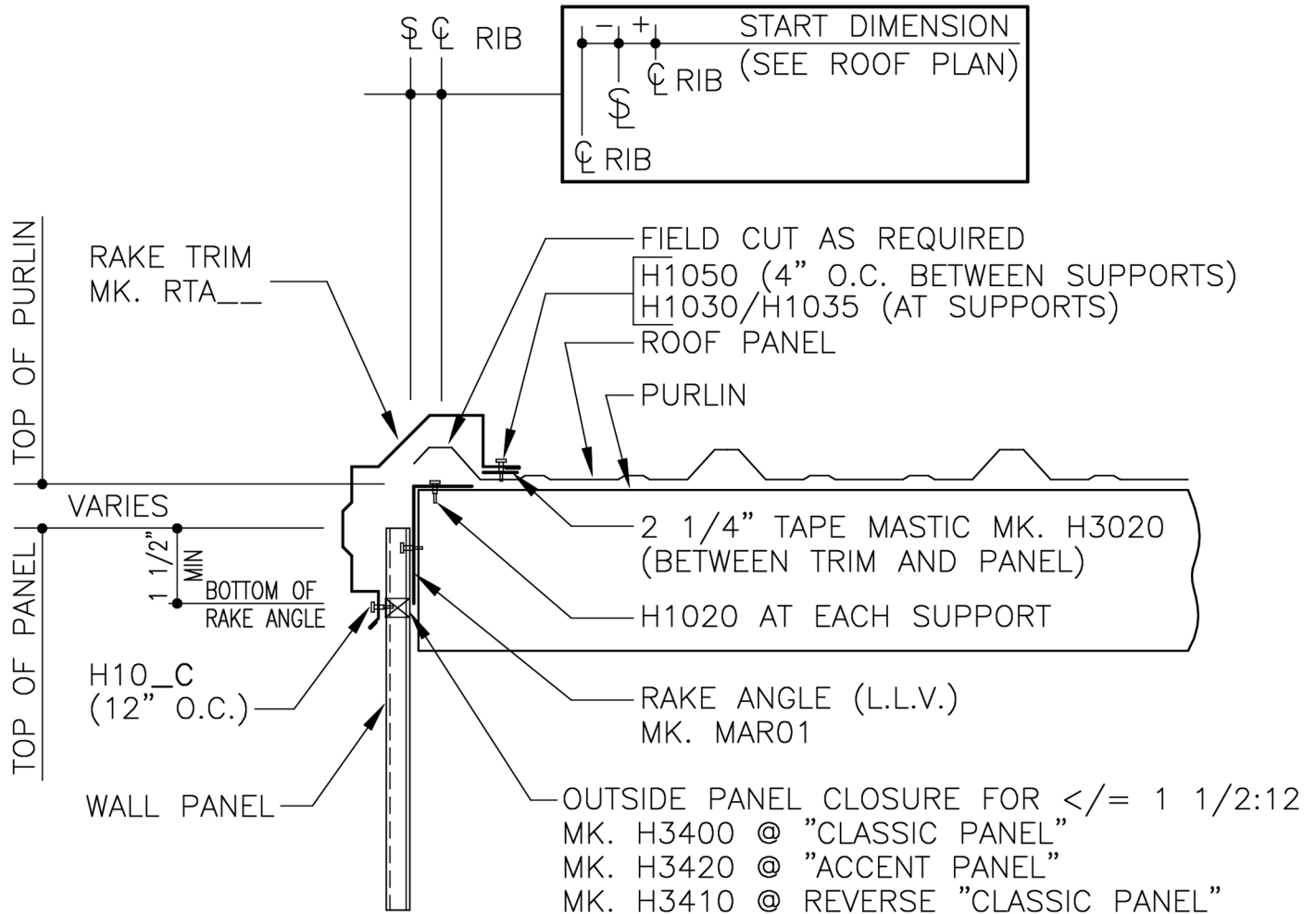

DE0010

SCULPTURED RAKE DETAIL

"CLASSIC ROOF"

SEE WALL SHEETING ERECTION NOTES FOR
WALL PANEL FASTENER LOCATIONS

DE0010

WALL PANEL CLOSURES SHOWN HERE ARE OPTIONAL

LAST REVISION
DATE: 03/08/17
BY: EGB CHK: KMC

DETAIL NAME IF APPLICABLE
DE0010.DWG

11.4.18



PRODUCT & ENGINEERING MANUAL

DE0020 – SCULPTURED RAKE TRIM @ MASONRY WALL

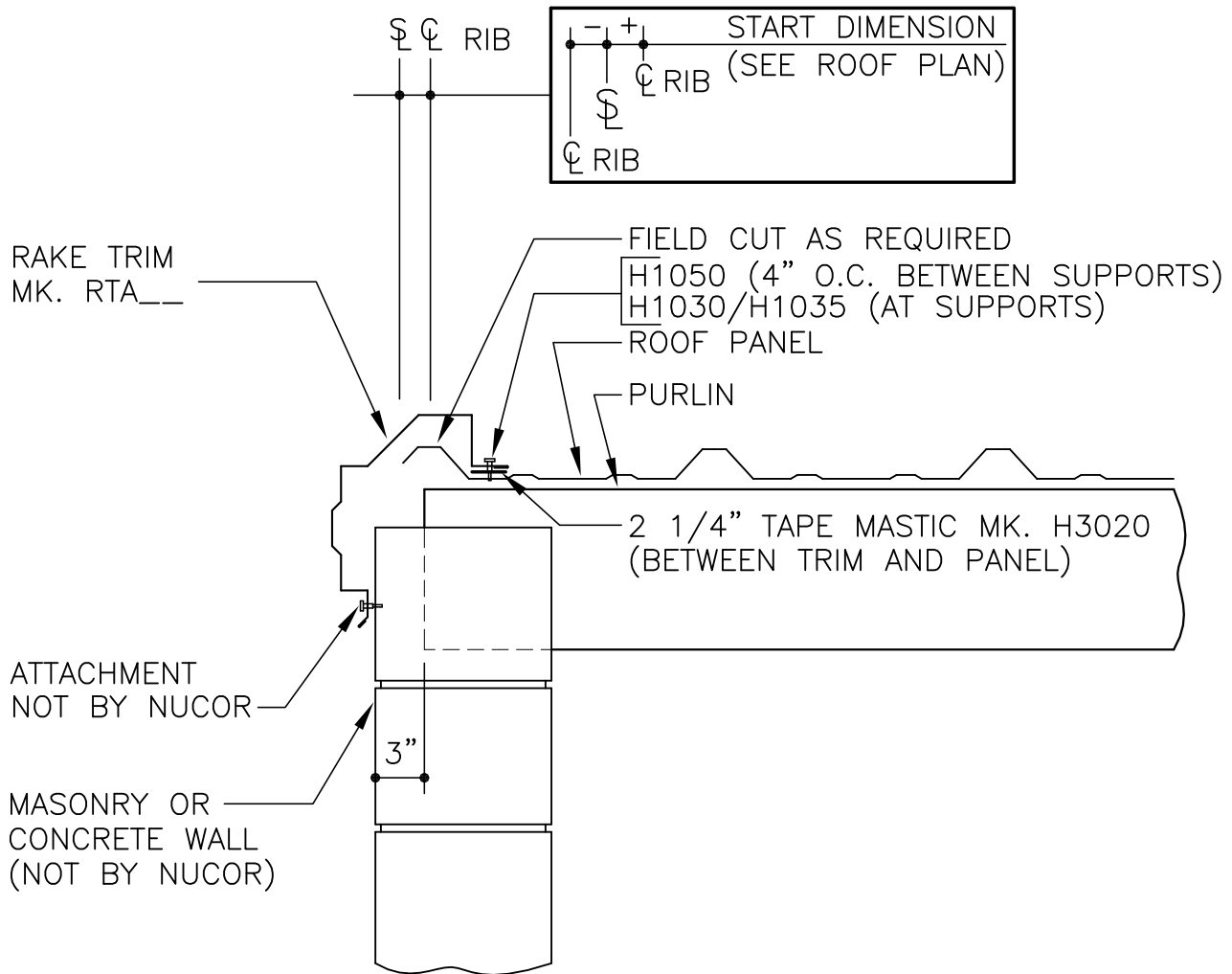

DE0020

SCULPTURED RAKE DETAIL

"CLASSIC ROOF" AT MASONRY WALL

DE0020

LAST REVISION
DATE: 11/09/15
BY: EGB CHK: AES

DETAIL NAME IF APPLICABLE
DE0020.DWG

11.4.19



PRODUCT & ENGINEERING MANUAL

DE0110 – SIMPLE RAKE TRIM @ STANDARD WALL

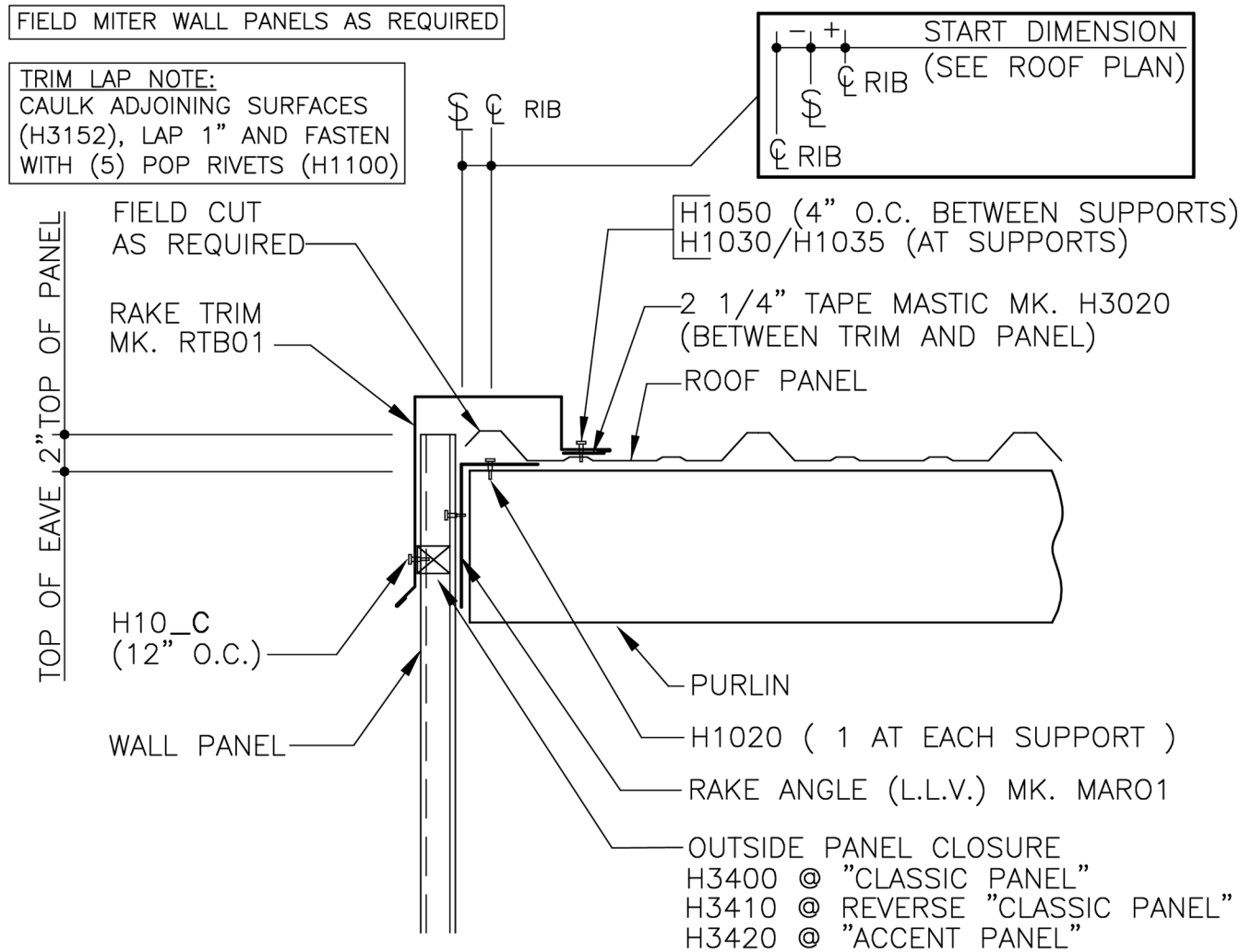

DE0110

SIMPLE RAKE DETAIL

"CLASSIC ROOF"

SEE WALL SHEETING ERECTION NOTES FOR
WALL PANEL FASTENER LOCATIONS

DE0110

WALL PANEL CLOSURES SHOWN HERE ARE OPTIONAL

LAST REVISION
DATE: 03/09/17
BY: EGB CHK: KMC

DETAIL NAME IF APPLICABLE
DE0110.DWG

11.4.20



PRODUCT & ENGINEERING MANUAL

DE0120 – SIMPLE RAKE TRIM @ MASONRY WALL

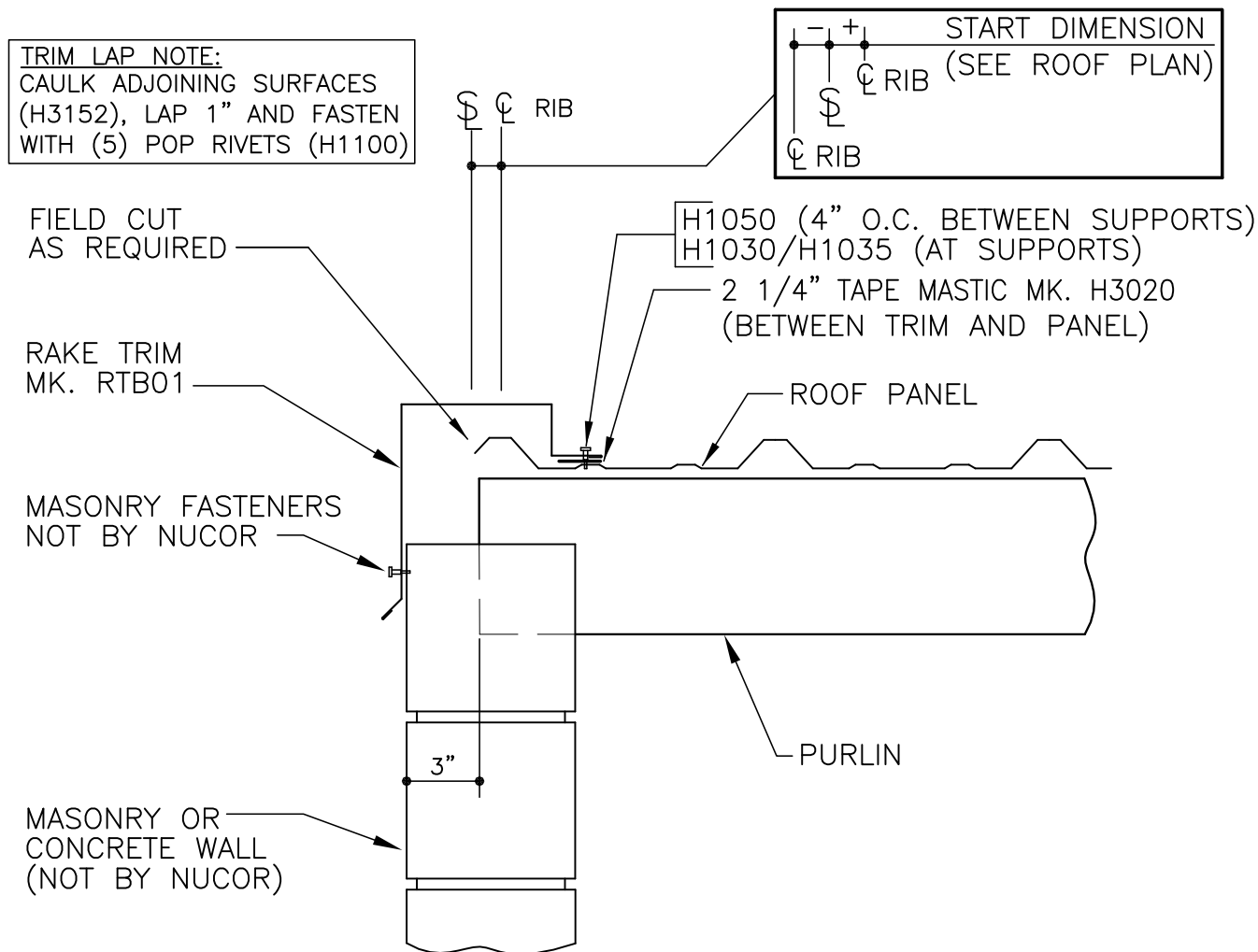

DE0120

SIMPLE RAKE DETAIL

"CLASSIC ROOF" AT MASONRY WALL

DE0120



PRODUCT & ENGINEERING MANUAL

DF0010 – RAKE PARAPET TRANSITION @ STANDARD WALL PANEL

NOTES:

ALWAYS BEGIN THE RAKE PARAPET TRIM INSTALLATION STARTING AT THE LOW EAVE AND WORK TOWARD THE HIGH EAVE OR RIDGE.

THE RAKE PARAPET TRIM IS DESIGNED TO HAVE "POSITIVE DRAINAGE" ONTO THE ROOF. THIS IS TO HELP ALLEVIATE THE POSSIBILITY OF WATER PONDING ON THE TRIM. SEE DETAIL "A" BELOW.

FASTEN THE RAKE PARAPET TRIM TO THE ROOF PANEL AT 4" ON CENTER.

REFER TO THE CLASSIC ROOF ERECTION MANUAL FOR ADDITIONAL TRIM LAP INFORMATION AND DETAILS.

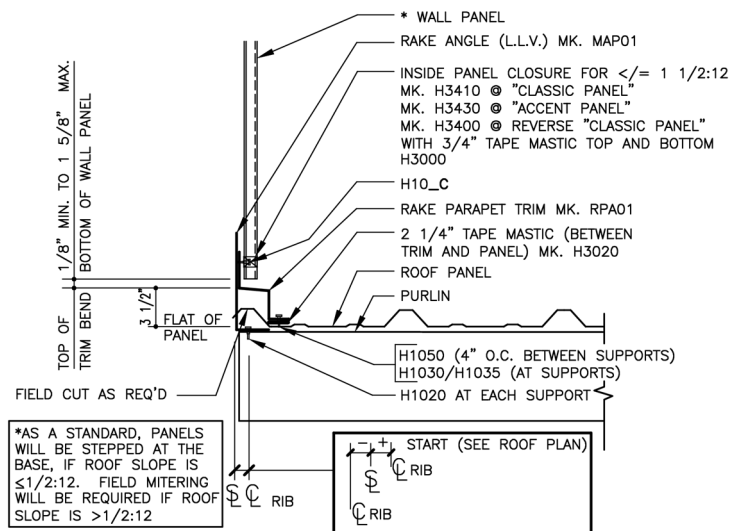
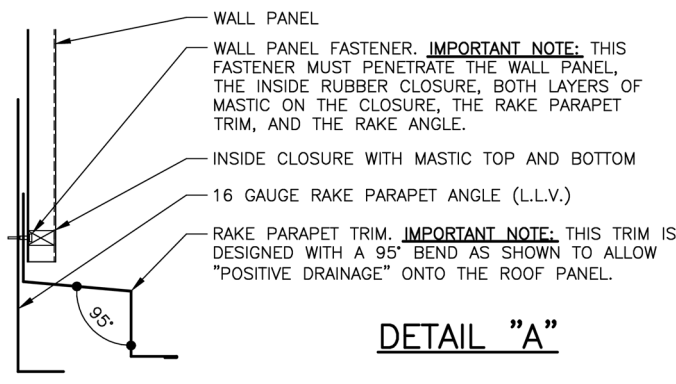

PARAPET RAKE DETAIL

"CLASSIC ROOF"

SEE WALL SHEETING ERECTION NOTES
FOR WALL PANEL FASTENER LOCATIONS

DF0010

LAST REVISION
DATE: 03/08/17
BY: EGB CHK: KMC

DETAIL NAME IF APPLICABLE
DF0010.DWG

11.4.22



PRODUCT & ENGINEERING MANUAL

DF0020 – RAKE PARAPET TRANSITION @ MASONRY WALL

NOTES:

ALWAYS BEGIN THE RAKE PARAPET TRIM INSTALLATION STARTING AT THE LOW EAVE AND WORK TOWARD THE HIGH EAVE OR RIDGE.

THE RAKE PARAPET TRIM IS DESIGNED TO HAVE "POSITIVE DRAINAGE" ONTO THE ROOF. THIS IS TO HELP ALLEVIATE THE POSSIBILITY OF WATER PONDING ON THE TRIM. SEE DETAIL "A" BELOW.

FASTEN THE RAKE PARAPET TRIM TO THE ROOF PANEL AT 4" ON CENTER.

REFER TO THE CLASSIC ROOF ERECTION MANUAL FOR ADDITIONAL TRIM LAP INFORMATION AND DETAILS.

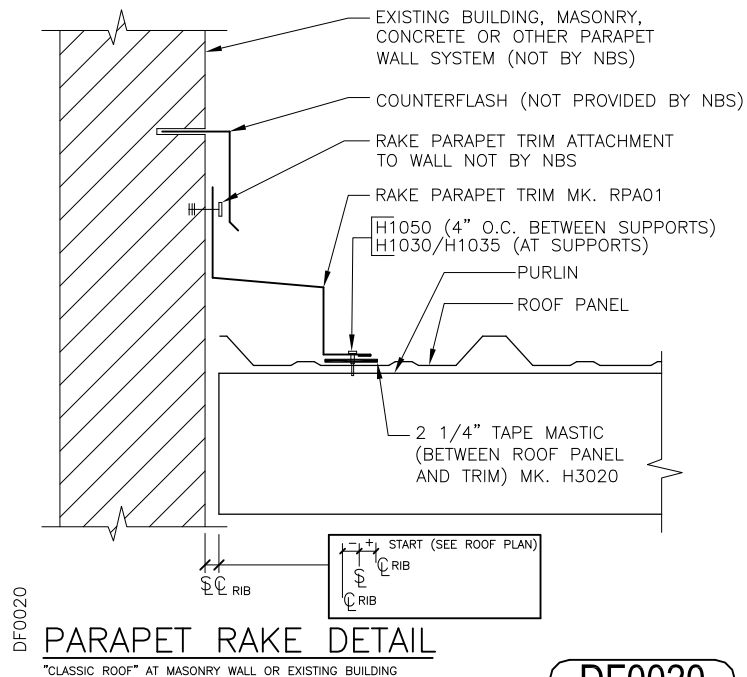
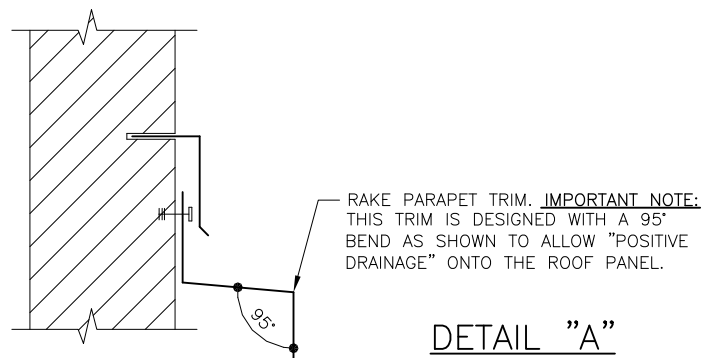

LAST REVISION
DATE: 11/09/15
BY: EGB CHK: AES

DETAIL NAME IF APPLICABLE
DF0020.DWG

11.4.23



PRODUCT & ENGINEERING MANUAL

RIDGE DETAILS DG0011 – RIDGE CONDITION WITH DIE FORMED RIDGE CAP

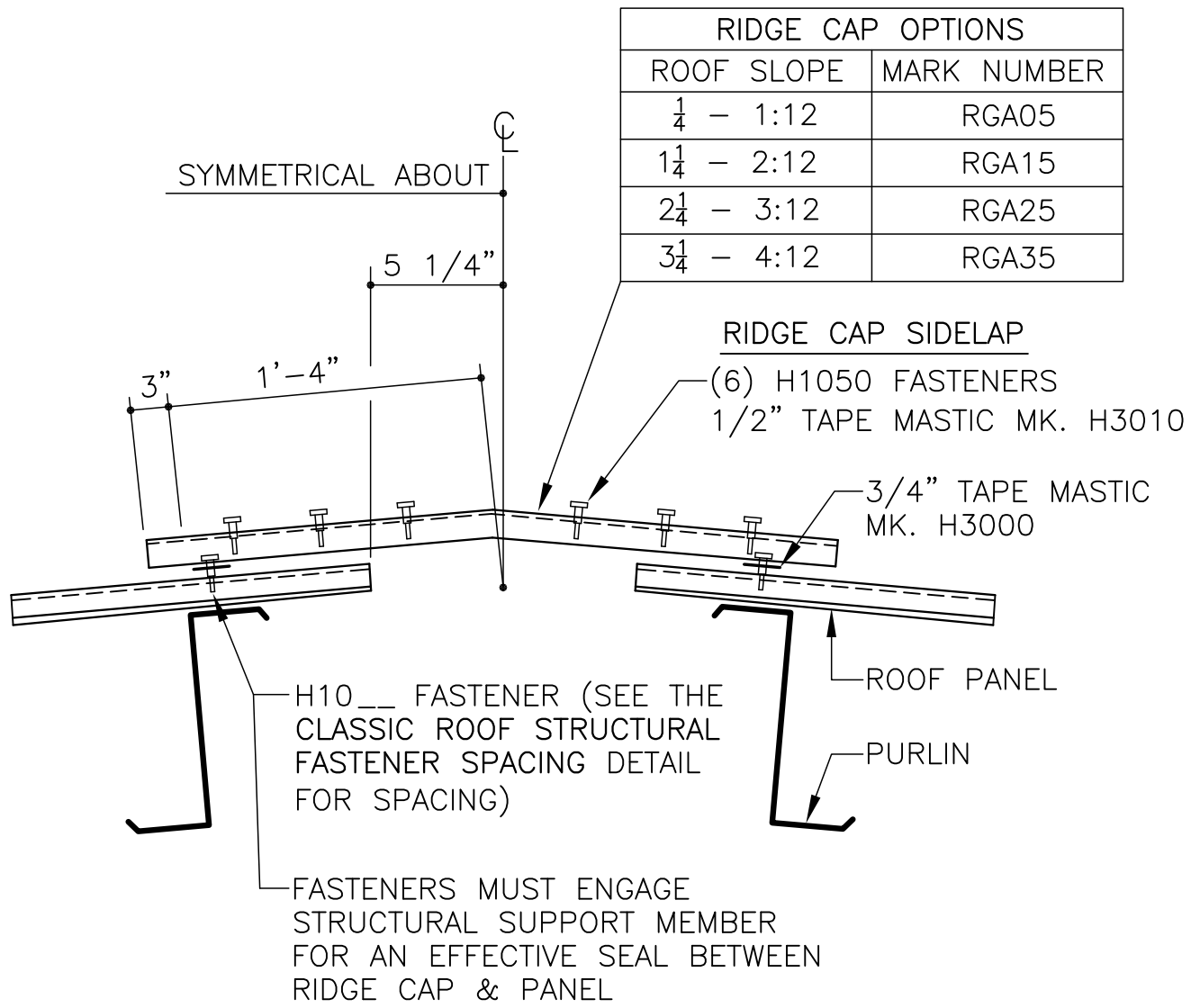

RIDGE DETAIL

"CLASSIC ROOF"
WITH $\leq 60'-0"$ PANEL RUN AND $\leq 4:12$ ROOF SLOPE

DG0011



PRODUCT & ENGINEERING MANUAL

DG0031 – RIDGE CONDITION WITH PRESS-BROKE RIDGE CAP

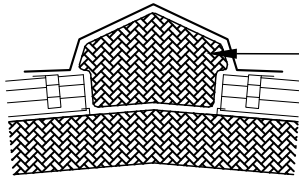

NOTE: FILL RIDGE CAP
VOID WITH
INSULATION

RIDGE CAP OPTIONS	
ROOF SLOPE	MARK NUMBER
$\leq 1:12$	RGG03
2:12 – 4:12	RGG03
5:12 – 7:12	RGG06
8:12 – 10:12	RGG09
11:12 – 12:12	RGG12

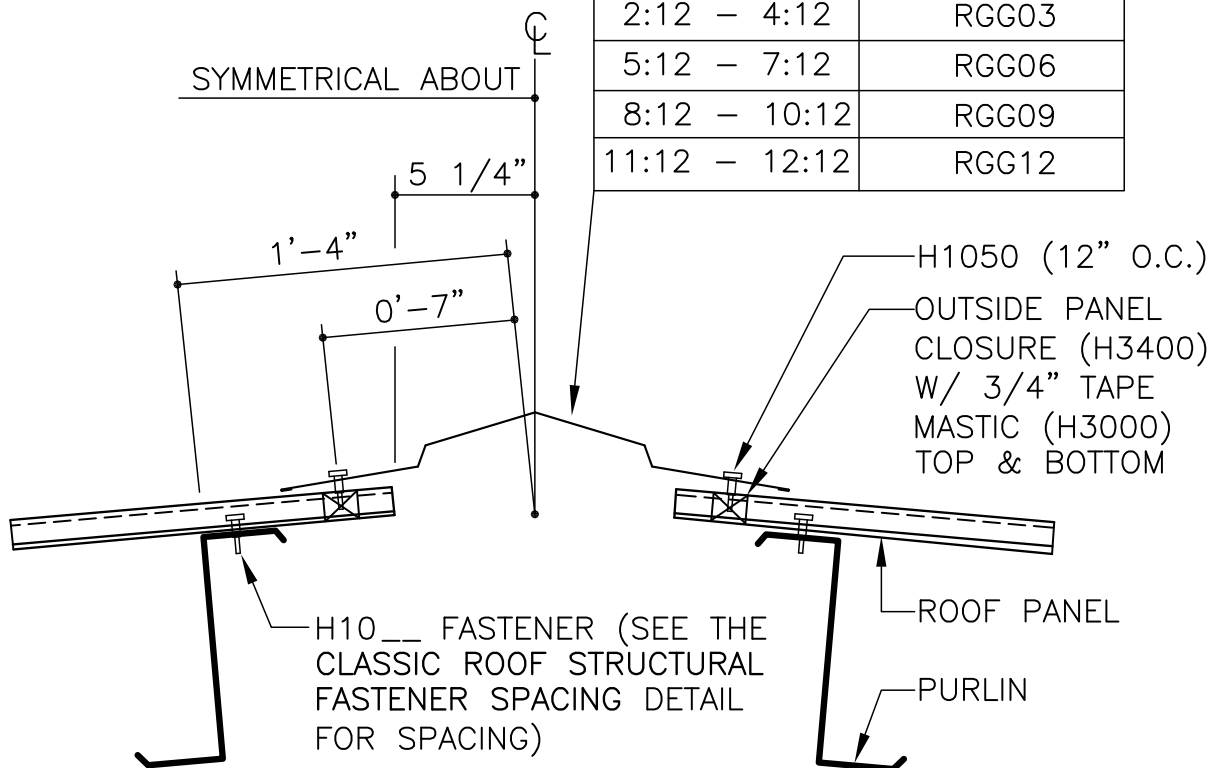

RIDGE DETAIL

"CLASSIC ROOF"

WITH $> 60'-0"$ PANEL RUN AND/OR
 $> 4:12$ ROOF SLOPE

DG0031



PRODUCT & ENGINEERING MANUAL

PANEL LAP DETAILS

DA0071 – PANEL LAP INSTALLATION

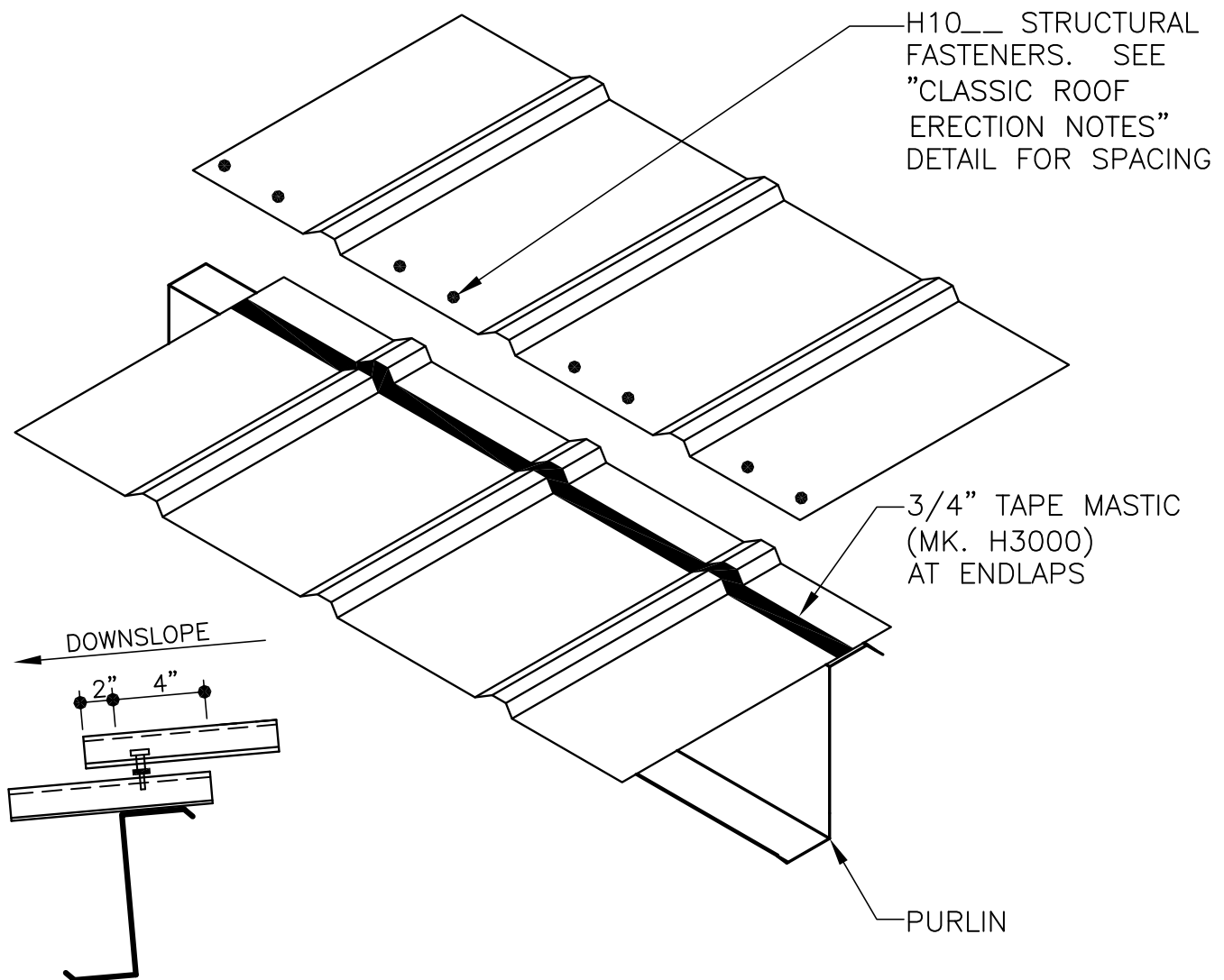

STANDARD "CLASSIC" ROOF LAP

DA0071

LAST REVISION
DATE: 02/16/15
BY: AK CHK: EGB

DETAIL NAME IF APPLICABLE
DA0071.DWG

11.4.26



PRODUCT & ENGINEERING MANUAL

HIP AND VALLEY DETAILS DN0010 – HIP CONDITION DETAIL

HIP CONDITION ERECTION NOTES

- 1) AFTER INSTALLATION OF THE PURLIN AT THE HIP AND BEFORE ROOF PANEL INSTALLATION, START THE INSTALLATION OF THE HIP PLATE AT THE LOW EAVE. NOTCH THE FIRST PIECE OF HIP PLATE AS REQUIRED. EXTEND THE HIP PLATE TO LINE UP WITH THE PANEL OVERHANG OF 5 1/4". FASTEN AT EACH PURLIN WITH (3) H1020 FASTENERS. LAP THE HIP PLATE 2" AND FASTEN WITH (2) H1020 FASTENERS.
- 2) IF YOUR BUILDING HAS ROOF INSULATION, IT MUST BE INSTALLED NOW. FASTEN THE INSULATION TO THE HIP PLATE AT 12" O.C. WITH H1020 SCREWS AND H2200 INSULATION WASHERS.
- 3) INSTALL ROOF PANELS. FIELD CUT PANELS AT THE PROPER ANGLE, 1 1/2" FROM THE HIP CENTERLINE.
- 4) RUN A CONTINUOUS PIECE OF 3/4" TAPE MASTIC (H3000) ON THE ROOF PANELS BASED ON DIMENSION IN CHART.
- 5) INSTALL THE METAL CLOSURE FROM THE HIP CENTERLINE BASED ON DIMENSION IN CHART, DIRECTLY OVER THE 3/4" TAPE MASTIC. FASTEN WITH (3) H1010 FASTENERS ON THE FLAT OF THE PANEL. APPLY TUBE CAULK (H3151) ON BOTH ENDS OF THE METAL CLOSURE AT THE HIGH RIB TO ENSURE WEATHERTIGHTNESS.
- 6) APPLY A CONTINUOUS PIECE OF 3/4" TAPE MASTIC (H3000) TO THE TOP OF THE METAL CLOSURE.
- 7) INSTALL THE HIP FLASH BY CENTERING IT OVER THE METAL CLOSURES FASTEN WITH (1) H1050 FASTENER AT EACH HIGH RIB AND AT 6" O.C.
- 8) FIELD WORK THE HIP CAP AT THE EAVE AND RIDGE AS REQUIRED TO ENSURE WEATHERTIGHTNESS.

METAL CLOSURE LOCATION	
HIP CONDITION	HIP FLASH
<input type="checkbox"/> DIE-FORMED	4.00 RGA
<input type="checkbox"/> HIP TRIM	4.00 HCT
<input type="checkbox"/> LOW PROFILE	6.50 RGA

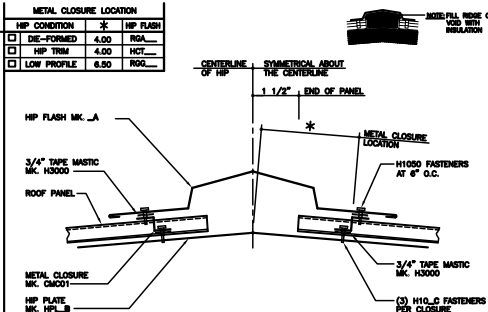

CLASSIC ROOF HIP CONDITION FINAL ASSEMBLY DETAIL

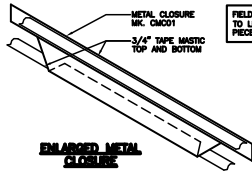
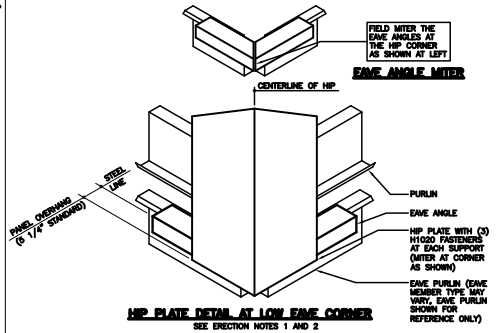

ENLARGED METAL CLOSURE

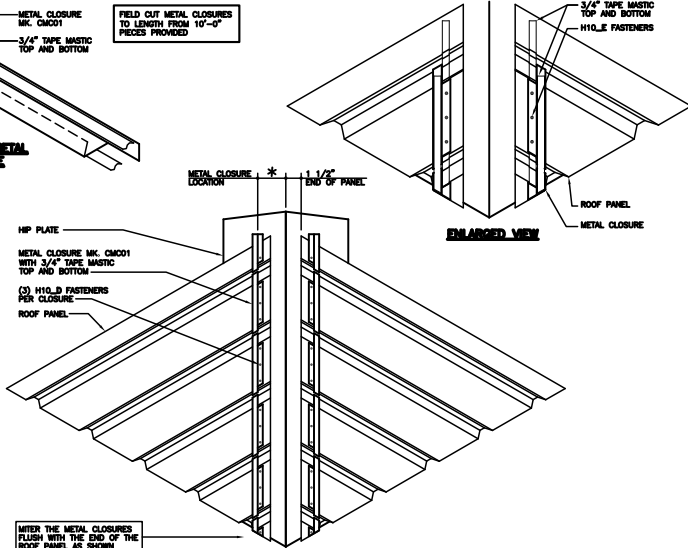

METAL CLOSURE AND MASTIC PLACEMENT DETAIL

SEE ERECTION NOTES 3, 4, AND 5

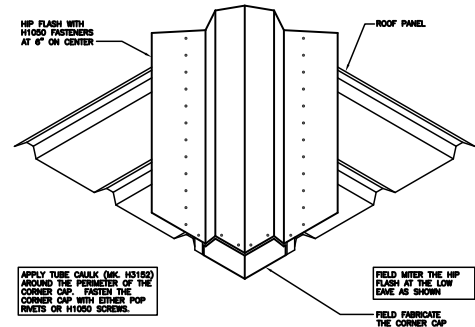

CORNER CAP DETAIL AT LOW EAVE

SEE ERECTION NOTES 7 AND 8



PRODUCT & ENGINEERING MANUAL

DD0100 – GUTTER CORNER DETAIL AT HIP

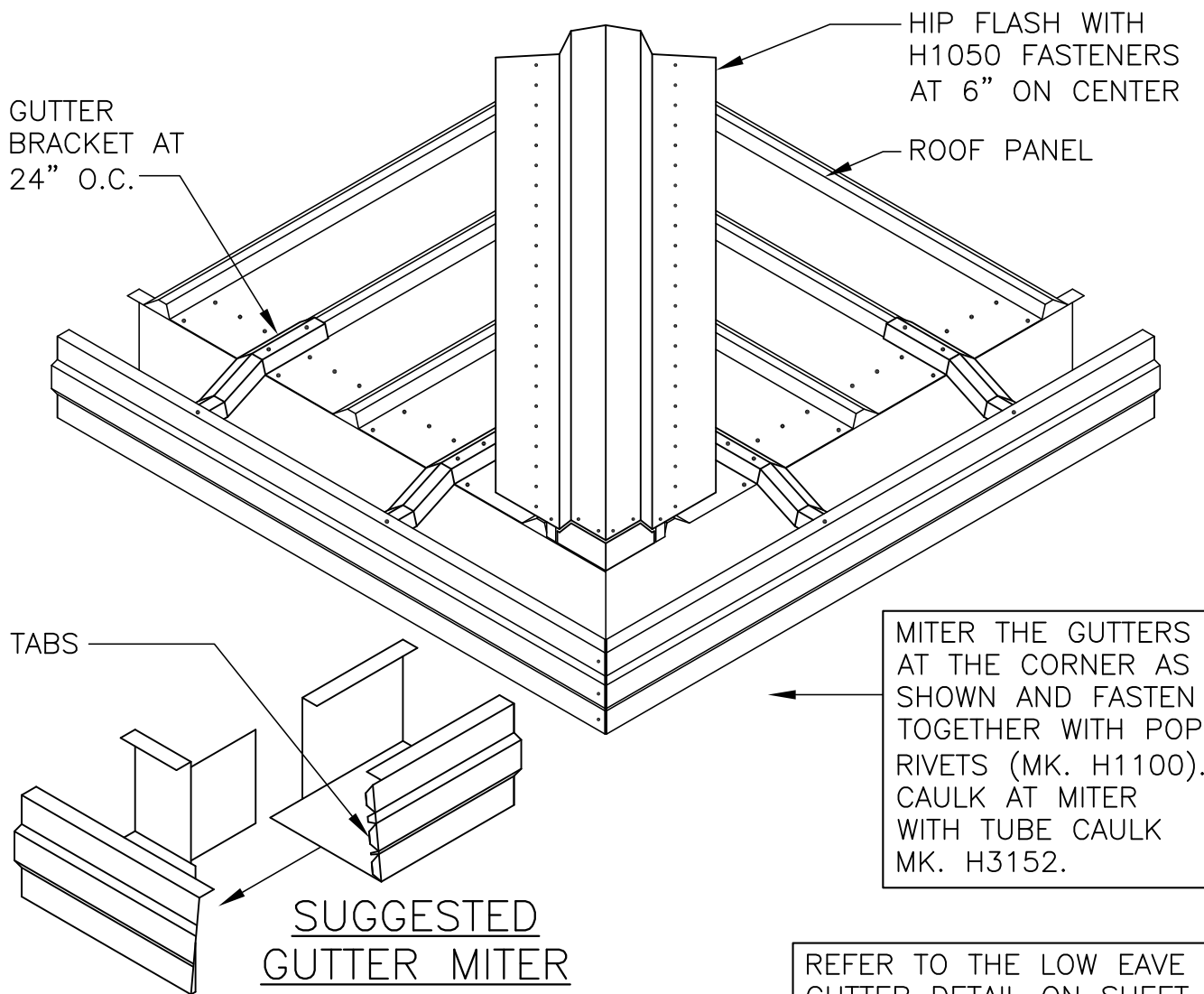

LOW EAVE GUTTER DETAIL AT HIP

REFER TO THE LOW EAVE
GUTTER DETAIL ON SHEET
D* FOR ADDITIONAL INFO

DD0100



PRODUCT & ENGINEERING MANUAL

DN0020 – VALLEY CONDITION DETAIL

VALLEY CONDITION ERECTION NOTES

- 1) START THE INSTALLATION OF THE VALLEY PLATE AT THE LOW EAVE. AFTER THE INSTALLATION OF THE PURLINS AND THE INSULATION, BEFORE PLACING THE VALLEY PLATE IN THE VALLEY, APPLY 3/4" TAPE MASTIC (H3020) UNDERNEATH THE PLATE ON THE EAVE ANGLE. EXTEND THE FIRST PIECE OF VALLEY PLATE TO LINE UP WITH THE PANEL OVERHANG OF 8 1/4". FASTEN THE VALLEY PLATE WITH (3) H1020 FASTENERS PER PURLIN AND LAP THE VALLEY PLATE 2" AND FASTEN WITH (2) H1020 FASTENERS.
- 2) PLACE DIVERTER FLASH OVER THE VALLEY PLATE AND TEMPORARILY FASTEN WITH (1) H1020 AT OUTSIDE CORNERS OF THE VALLEY PLATE (DO NOT USE THE VALLEY AS A WALKWAY OR A WORK PLATFORM).
- 3) INSTALL 2 1/4" TAPE MASTIC (H3020) ON THE DIVERTER FLASH 7 1/2" FROM THE CENTERLINE OF THE VALLEY (AS SHOWN).
- 4) INSTALL THE ROOF PANELS, CUTTING ENDS AT THE REQUIRED ANGLE. CUT THE PANELS 7" FROM THE CENTERLINE OF THE VALLEY. (NOTE: KEEP METAL SHIMMED OUT OF THE TAPE MASTIC.) PLACE (3) H1020 FASTENERS IN THE FLAT OF PANEL (EQUALLY SPACED), CENTERED OVER THE 2 1/4" TAPE MASTIC (H3020) AS SHOWN.
- 5) INSTALL THE PLASTIC RIB COVERS BY APPLYING A GENEROUS BEAD OF TUBE CAULK (H1015) TO THE ENTIRE PERIMETER OF THE RIB COVER. CENTER THE RIB COVER OVER THE PANEL RIB AND FASTEN WITH (6) H1015 SCREWS AT ALL PRE-PUNCHED HOLES.
- 6) FIELD WORK THE HIGH AND LOW ENDS OF THE VALLEY AS REQUIRED TO ENSURE WEATHERTIGHTNESS.

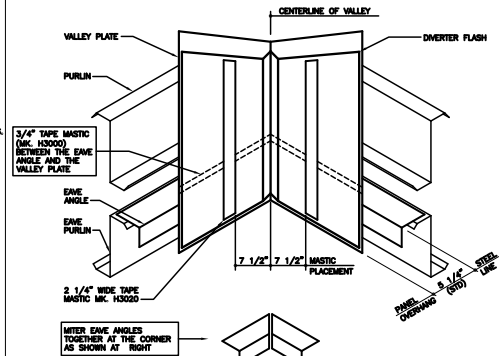
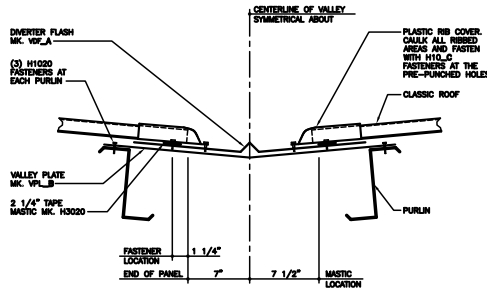

CLASSIC ROOF

CLASSIC ROOF VALLEY CONDITION FINAL ASSEMBLY DETAIL

VALLEY PLATE DETAIL AT LOW EAVE CORNER

SEE ERECTION NOTES 1, 2, AND 3

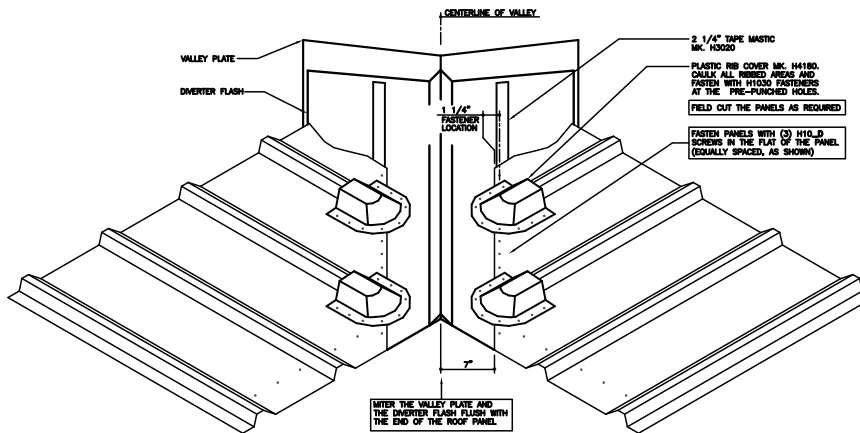

CLASSIC ROOF VALLEY DETAIL

SEE ERECTION NOTES 4, 5, AND 6

LAST REVISION
DATE: 02/16/15
BY: AK CHK: EGB

DETAIL NAME IF APPLICABLE
DN0020.DWG

11.4.29



PRODUCT & ENGINEERING MANUAL

DD0200 – GUTTER CORNER DETAIL AT VALLEY

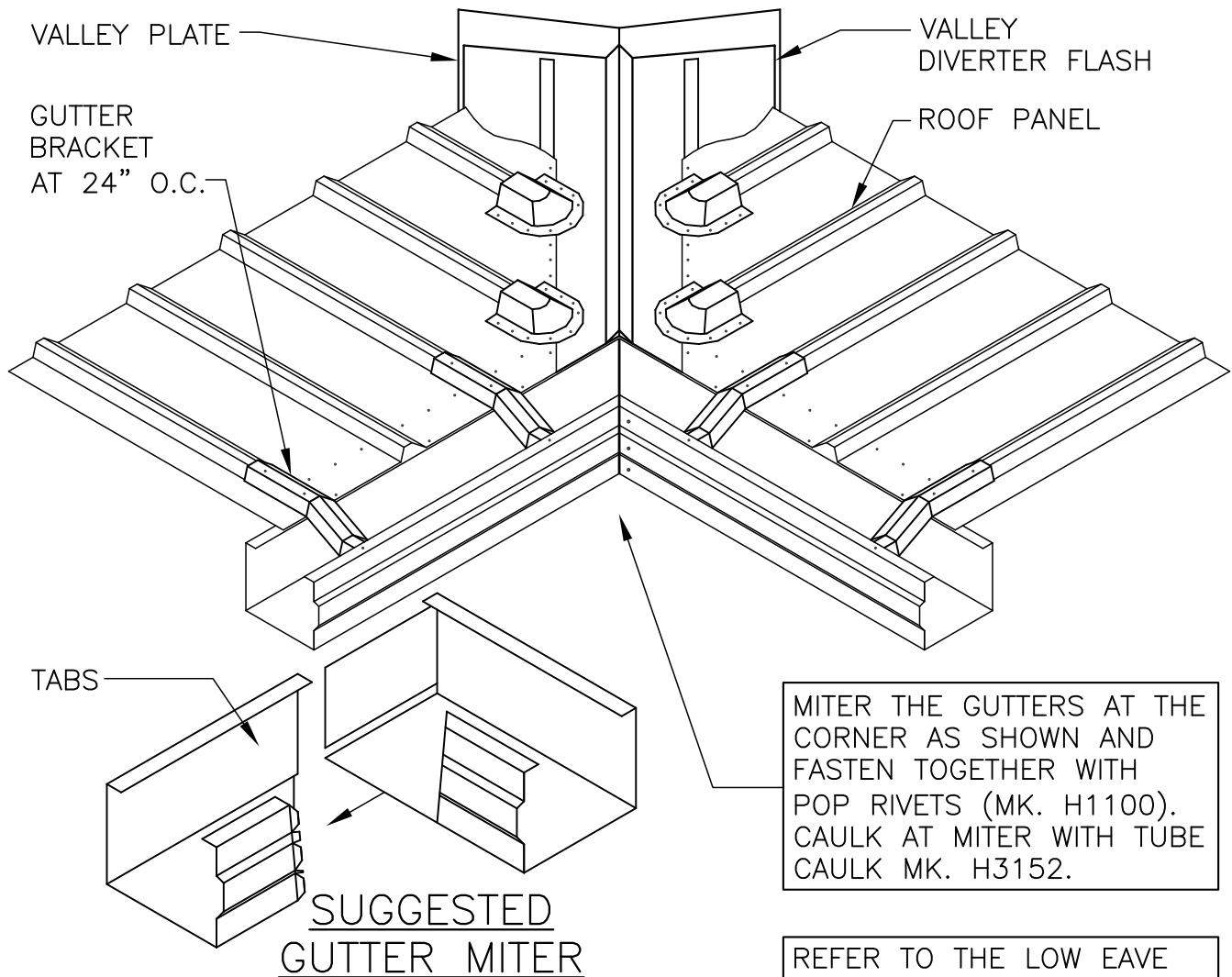

LOW EAVE GUTTER DETAIL AT VALLEY

DD0200